

T.1S.,R.39E.,W.M.

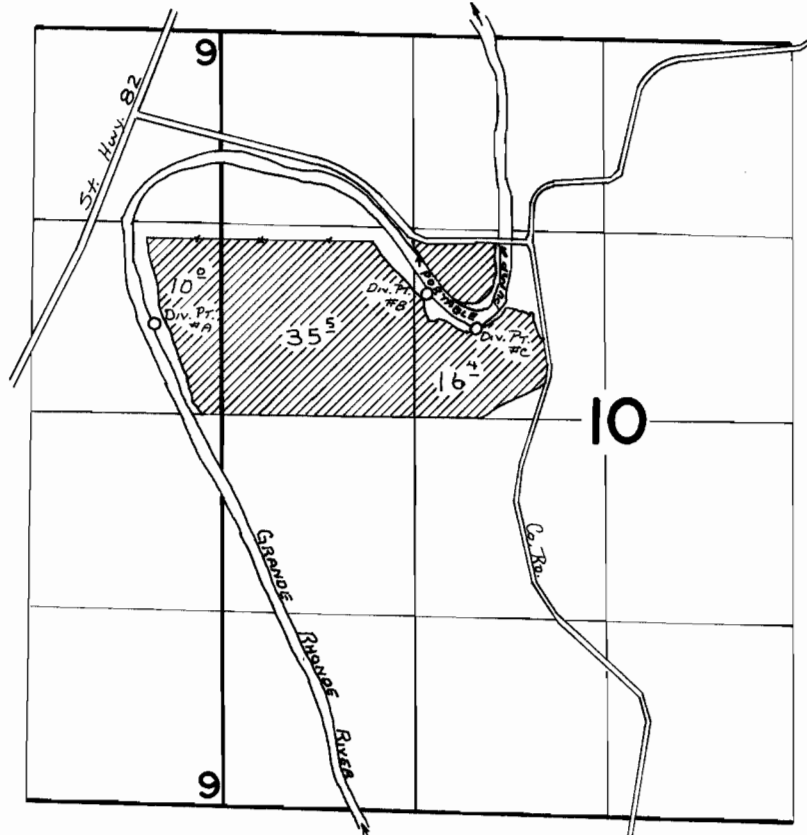

Div. Pt. #A - 620' N AND 460' W

Div. Pt. #B - 840' N AND 1420' E

Div. Pt. #C - 620' N AND 1750' E

PORTABLE PUMPING BETWEEN POINTS 1220' N AND 1320' E & 1210' N AND 1900' E

ALL FROM W 1/4 COR
SEC. 10

FINAL PROOF SURVEY

UNDER

Application No. 42218... Permit No. 31604...
IN NAME OF

J. G. & ALYCE WHITEMORE

Surveyed SEPT. 14 1974, by L. H. NUNN