

T.1&2N.R.12&13E.W.M.

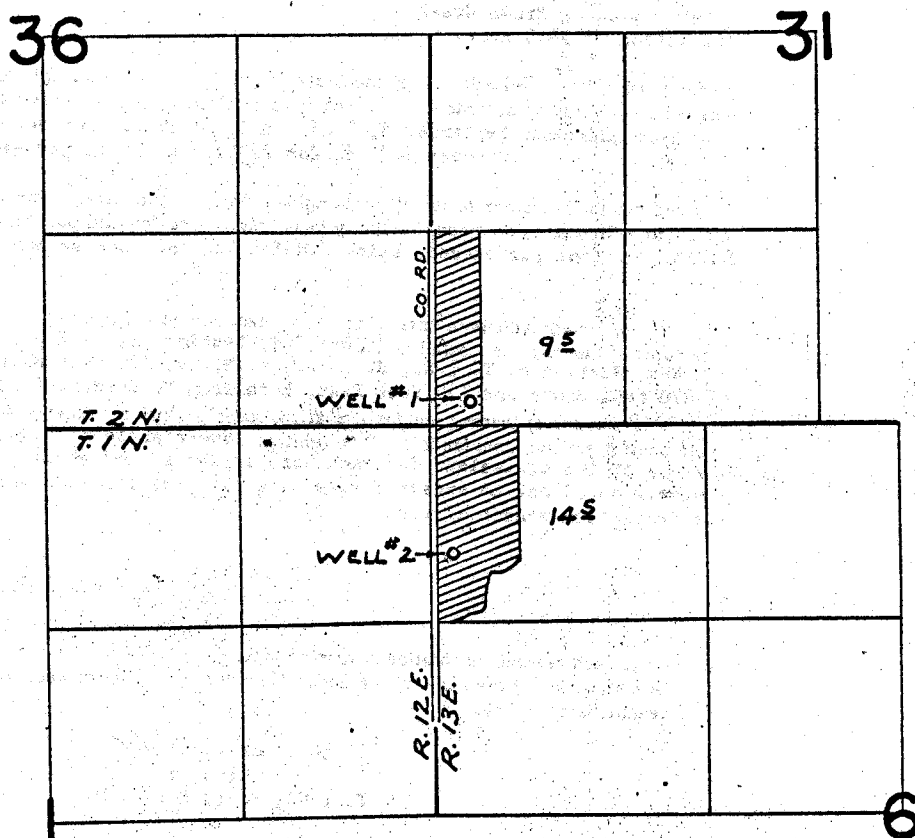

WELLS LOC: #1 - 170' N. & 260' E ; #2 - 870' S. & 130' E., BOTH FROM N.W. COR. SEC. 6

FINAL PROOF SURVEY
UNDER

Application No. G-3226 Permit No. G-2924
IN NAME OF

ROBERT D. KRUEGER

Surveyed APR. 24, 1974, by D. NORBY