

T.27S. R.13W. W.M.

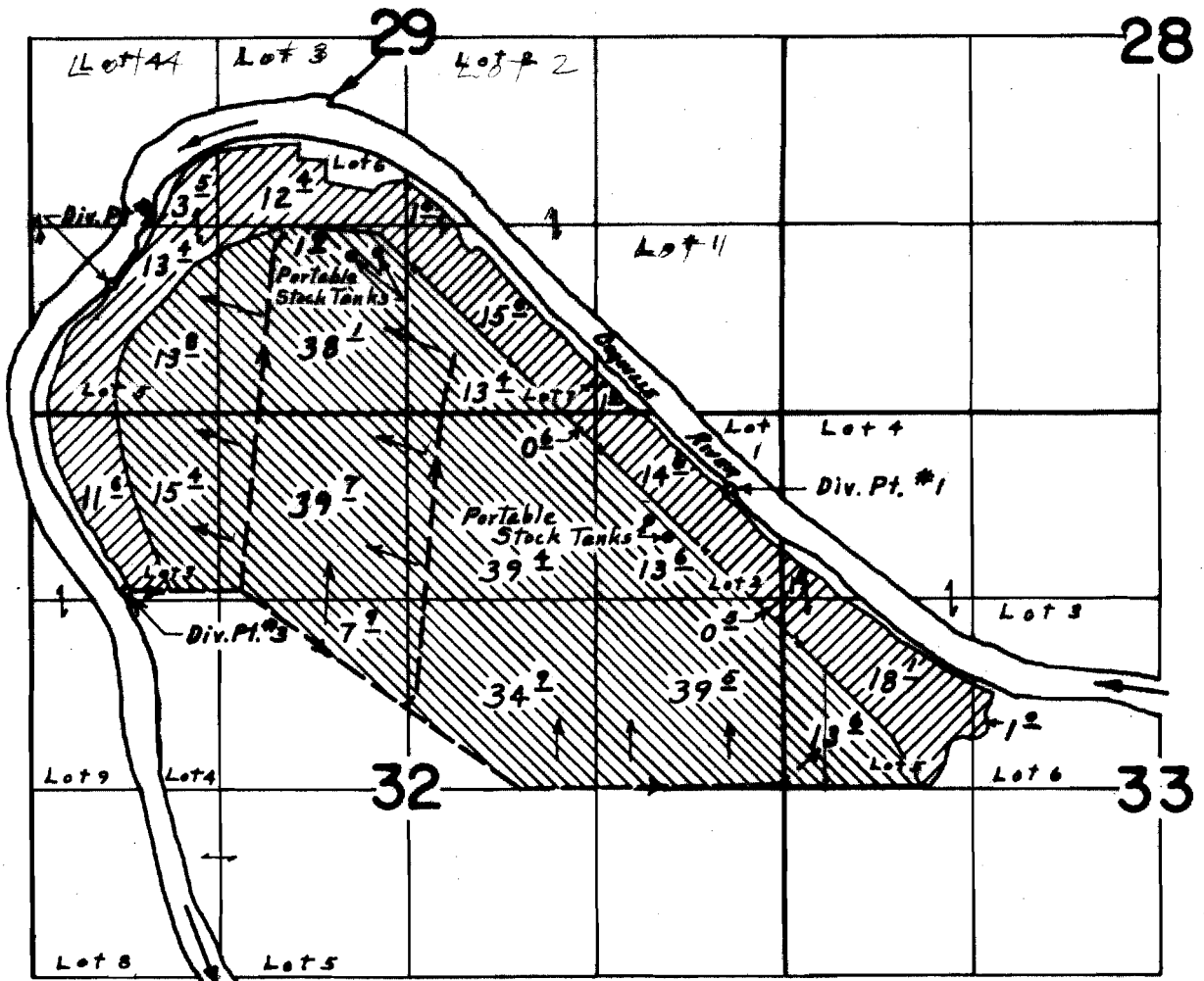

Div. Pts. located: #1, 530'S. & 370'W.; #2, 900'N. & 4600'W.; #3, 1240'S. & 4580'W.; all from N.E. Corner Section 32

FINAL PROOF SURVEY
UNDER

Application No. 42051 Permit No. 31475
IN NAME OF

Royburn & Fred Guerin

Surveyed 1 Aug. 1974 by Larry Nunn
14 July 1972 by Z.E. Gump