

T.33S. R.6 & 7-1/2 E. W.M.

T.33S. R.6E. W.M.

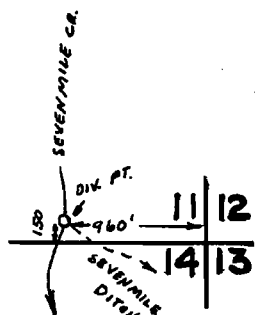

Seven mile creek

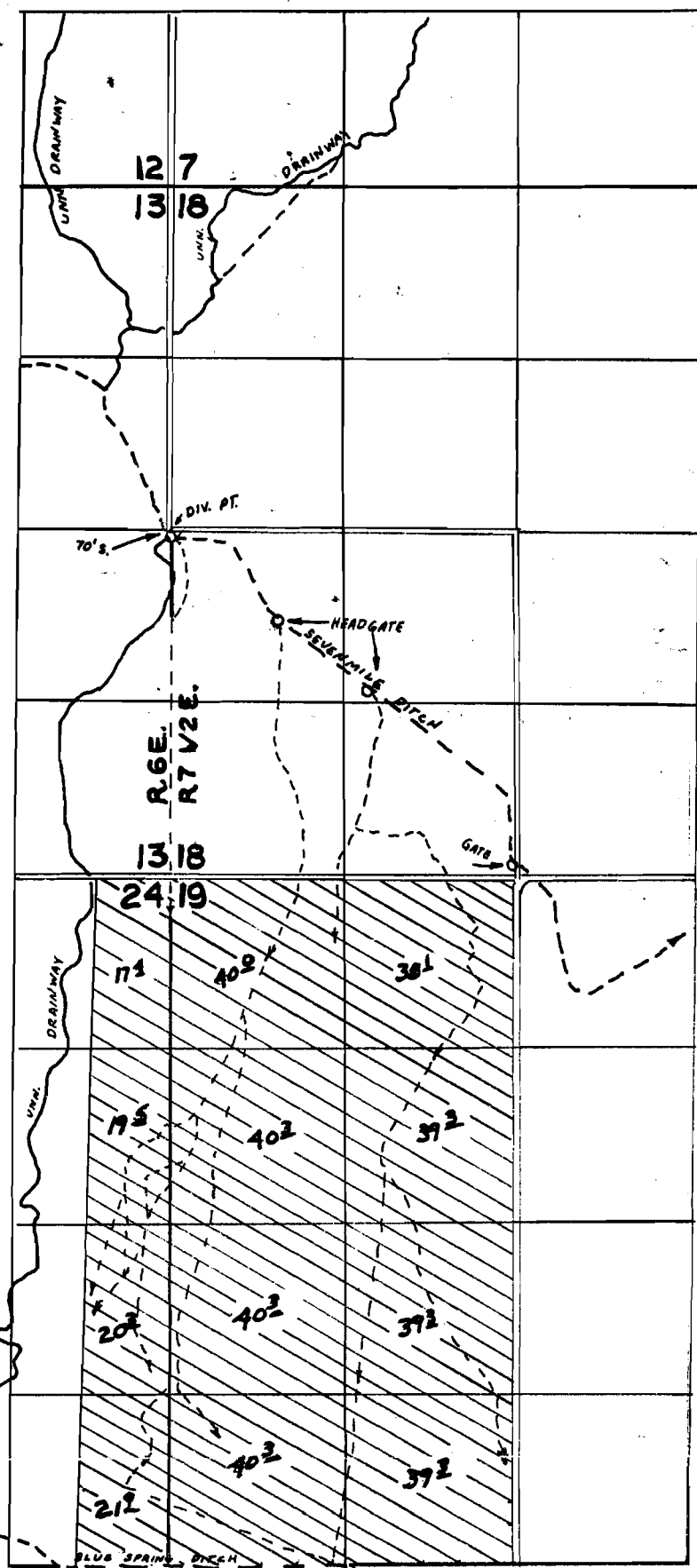

FINAL PROOF SURVEY UNDER

**FINAL PROOF SURVEY
UNDER**

APPLICATION No. ⁴⁷¹⁹⁶47197 PERMIT No. ³⁵⁵²³35524

IN NAME OF

LLOYD NICHOLSON

SURVEYED OCT. 19, 1974 BY L H NUNN

CNO-233-9 LHN