

T.5S. R.1W. W.M.

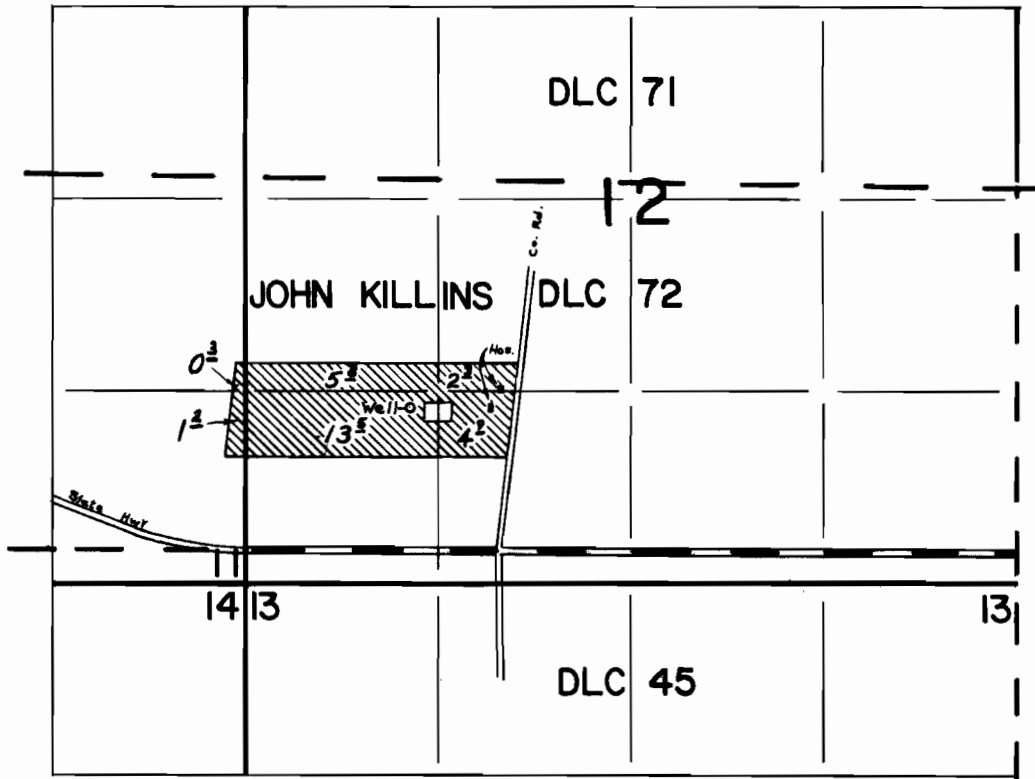

Well Located: 1000' N. & 4150' W. from S.E. cor. John Killins DLC 72

FINAL PROOF SURVEY UNDER

Application No. G-4990 Permit No. G-4708
IN NAME OF

.....LOWELL HALL.....

Surveyed JUNE 17, 1974, by L.E. GOULD