

T.26 S.R.4 W.W.M.

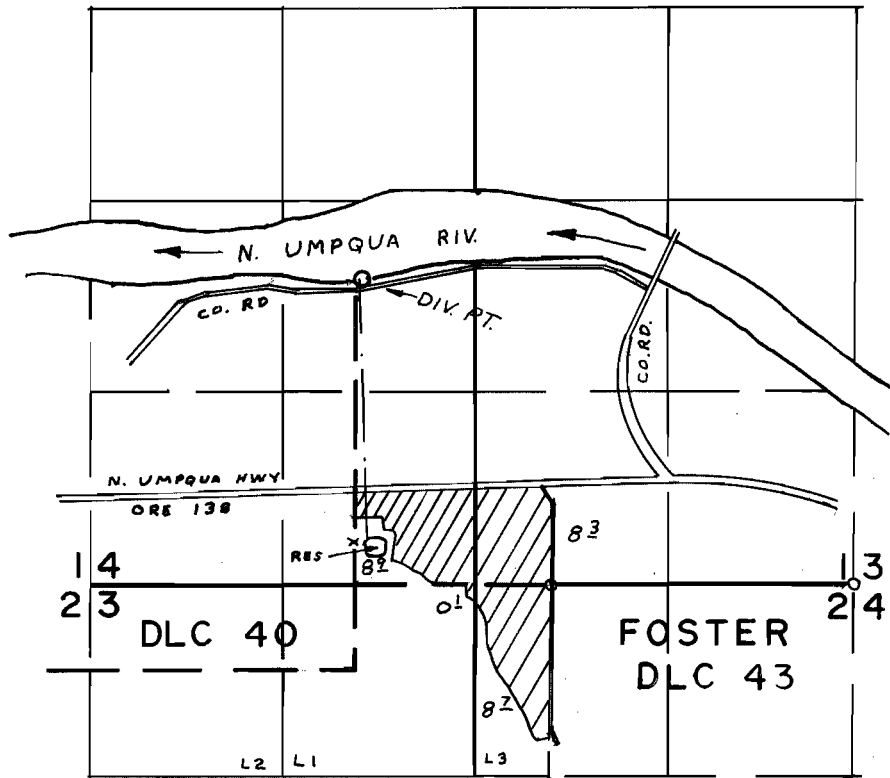

DIV. PT. LOC. 2080' N & 770' W FROM SE COR. SEC. 14

FINAL PROOF SURVEY UNDER

Application No. 50476 Permit No. 37316
IN NAME OF

GLEN W. WECKS

Surveyed AUG. 29 1974, by L. H. NUNN