

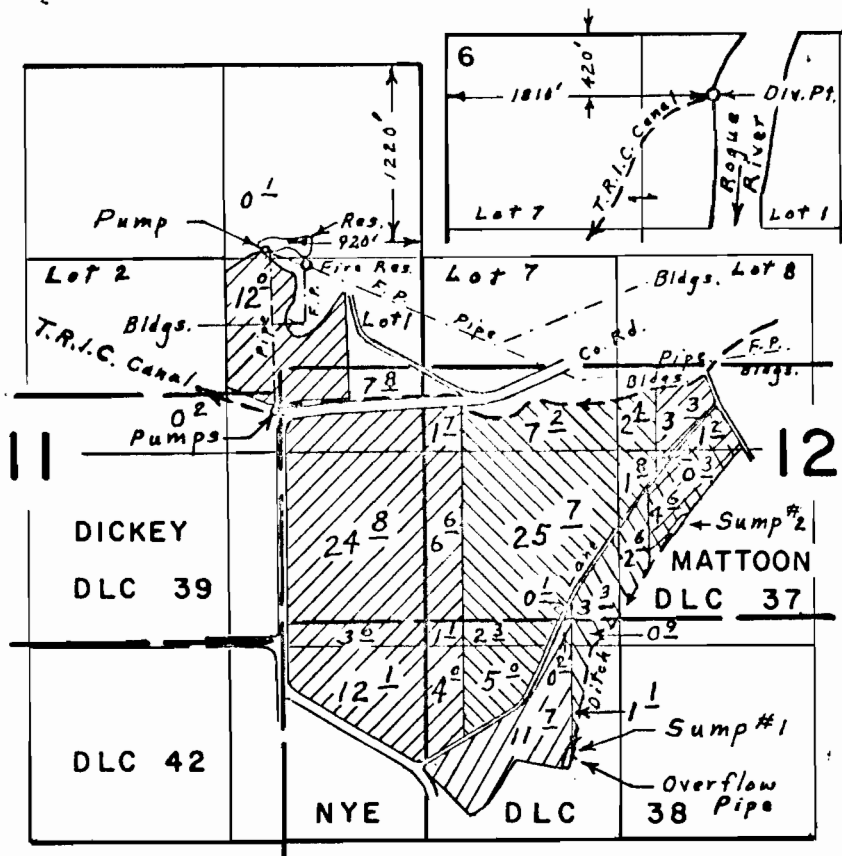



T.36S. R.2W. W.M.

T.36S. R.1W. W.M.



Sump #1: 750' S. & 1940' E., Sump #2: 800' N. & 2700' E both from NE cor. DLC. 42

FINAL PROOF SURVEY UNDER

G- 5740 G - 4973 S.#1  S.#2 
 49032 35934
 R-47768 R - 5767
 Application No. 47769. Permit No. 35777. 
 IN NAME OF

MODOC ORCHARD COMPANY

Surveyed Sept. 26 1973, by L. E. Gould