

# T.36S. R.2W. W.M.

## T.36S. R.1W. W.M.

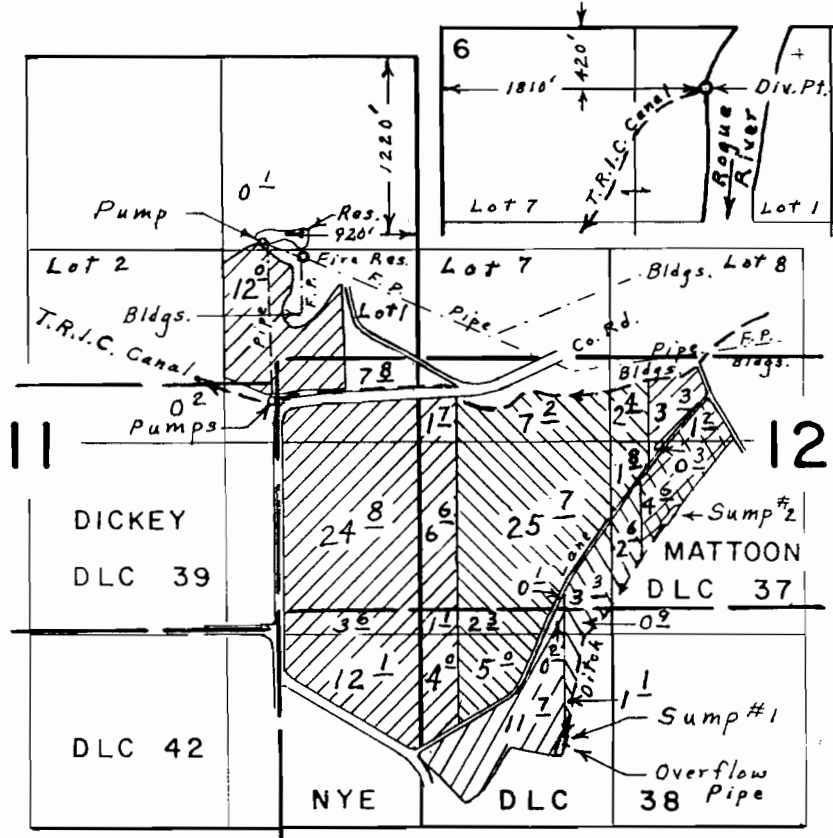

Sump #1: 750' S. & 1940' E., Sump #2: 800' N. & 2700' E both from NE cor. DLC. 42

### FINAL PROOF SURVEY UNDER

G- 5740  
49032  
R-47768

G-4973 S.#1  
35934  
R-5767

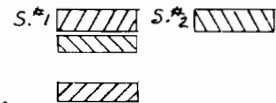

Application No. 47769 Permit No. 35777

IN NAME OF

MODOC ORCHARD COMPANY

Surveyed Sept. 26, 1973, by L. E. Gould