

T.36S. R.2W. W.M.

T.36S. R.1W. W.M.

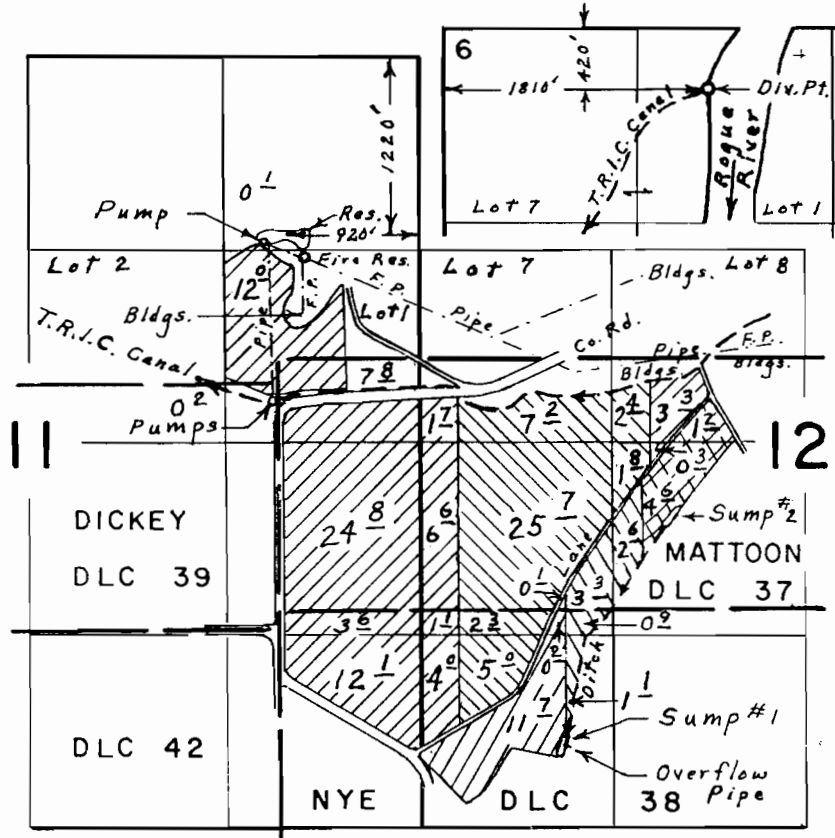

Sump #1 - 750' S. & 1940' E., Sump #2 - 800' N. & 2700' E both from NE cor. DLC. 42

FINAL PROOF SURVEY UNDER

G- 5740
49032
R-47768

G- 4973
35934
R- 5767

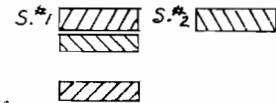

Application No. 47769 Permit No. 35777

IN NAME OF

MODOC ORCHARD COMPANY

Surveyed Sept. 26 1973, by L. E. Gould