

T. 36 & 37 S. R. 11 & 12 E. W.M.

Whiskey Creek: main

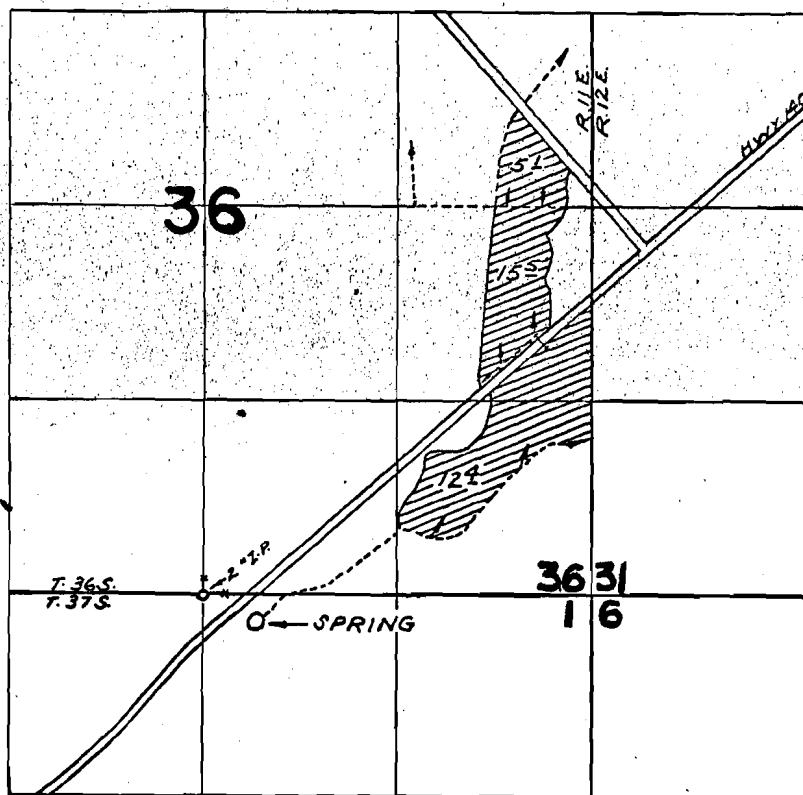

SPRING LOC: 170'S. & 350'E. FROM N 1/4 COR. SEC. 1

FINAL PROOF SURVEY UNDER

Application No. 46330... Permit No. 34494...
IN NAME OF

WILLIAM L. GALLAGHER & FRANK E. McBAIN, JR.

Surveyed OCT. 24, 1977, by R. MUCKEN.