

T.18S. R.46E. W.M.

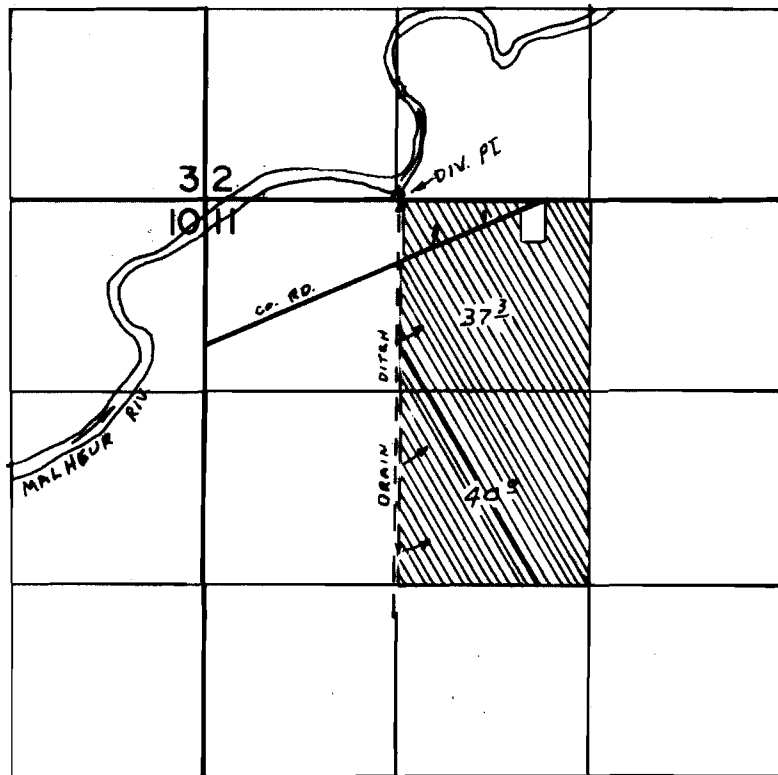

DIV. PT. LOC. 40' N. FROM NW COR. OF NE 1/4 NW 1/4
SEC. 11

FINAL PROOF SURVEY UNDER

Application No. 46312 Permit No. 34604
IN NAME OF

ROBERT GARRETT

Surveyed JUN. 18. 1974, by L.H. NUNN