

T.14 S.R.7 & 8 W.W.M.

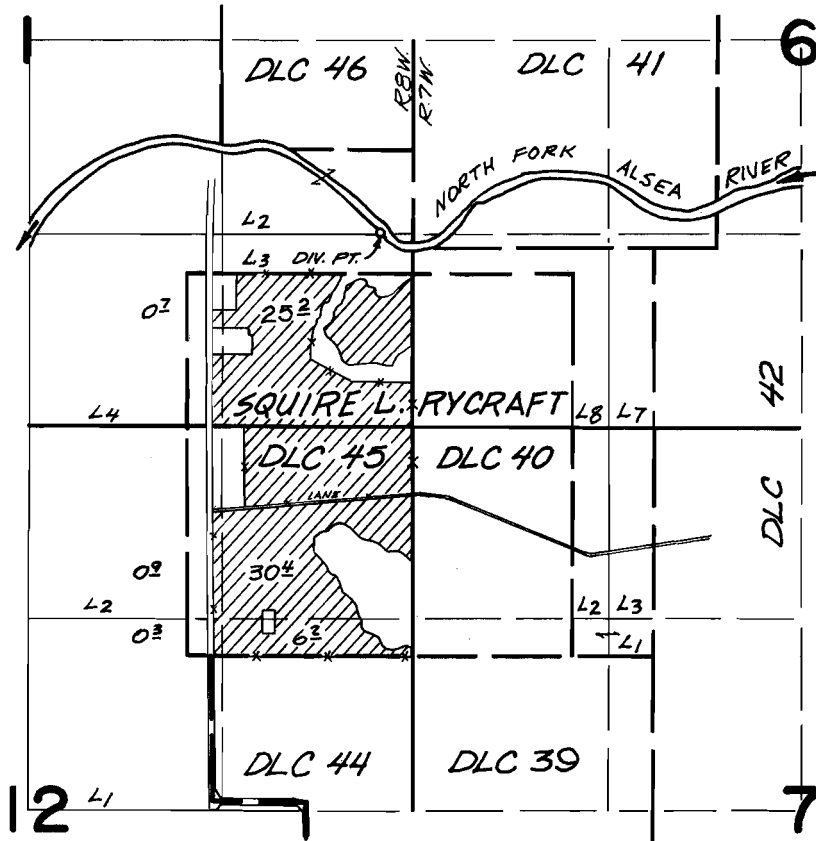

DIV. PT. 1330' N., 210' W. FROM S.E. COR. SEC. 1, T.14S., R.8W., W.M.M.

FINAL PROOF SURVEY UNDER

Application No. 43938 Permit No. 32831
IN NAME OF

ERMINE L. & RUTH G. WALTER

Surveyed NOV. 7 1974, by L.M. TOLL