

T. 29 S. R. 4 W. W.M.

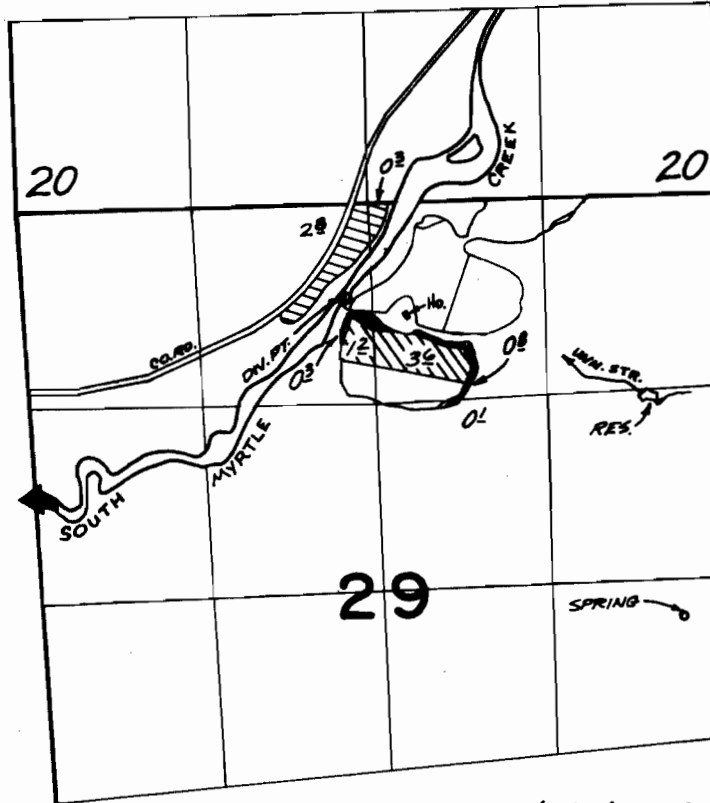

CREEK; 640' S. & 170' W. RES; 1340' S. & 1830' E. SPRING; 2910' S. & 2070' E. ALL FROM N. 1/4 CORNER SECTION 29.



PRIMARY FROM CREEK



PRIMARY FROM STREAM AND RESERVOIR



SUPPLEMENTAL FROM RESERVOIR ONLY

FINAL PROOF SURVEY UNDER

R 45310 R 5348
Application No. 45320 Permit No. 33831
IN NAME OF

PAT D. PRICE

Surveyed JUNE 18 1974, by D. NORBY