

# T.IOS.R.IOW.W.M.

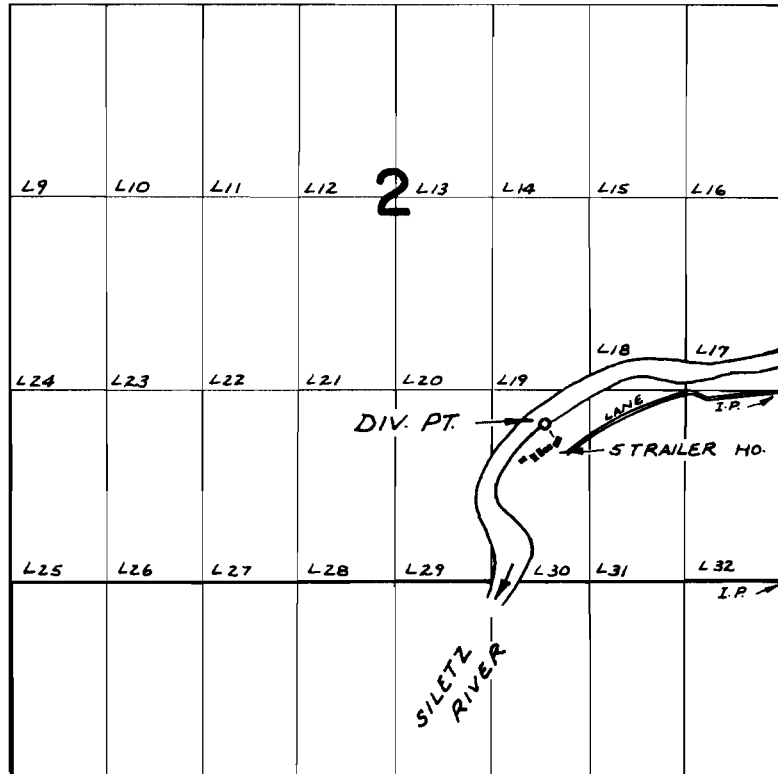

DIV. PT. LOC: 1080' N & 1620' W. FROM S.E. COR. SEC. 2

## FINAL PROOF SURVEY UNDER

Application No. 49263 Permit No. 36923  
IN NAME OF

GLEN R. EDENFIELD

Surveyed AUG. 27 1974, by R. MUCKEN