

T.6S.R.1E.W.M.

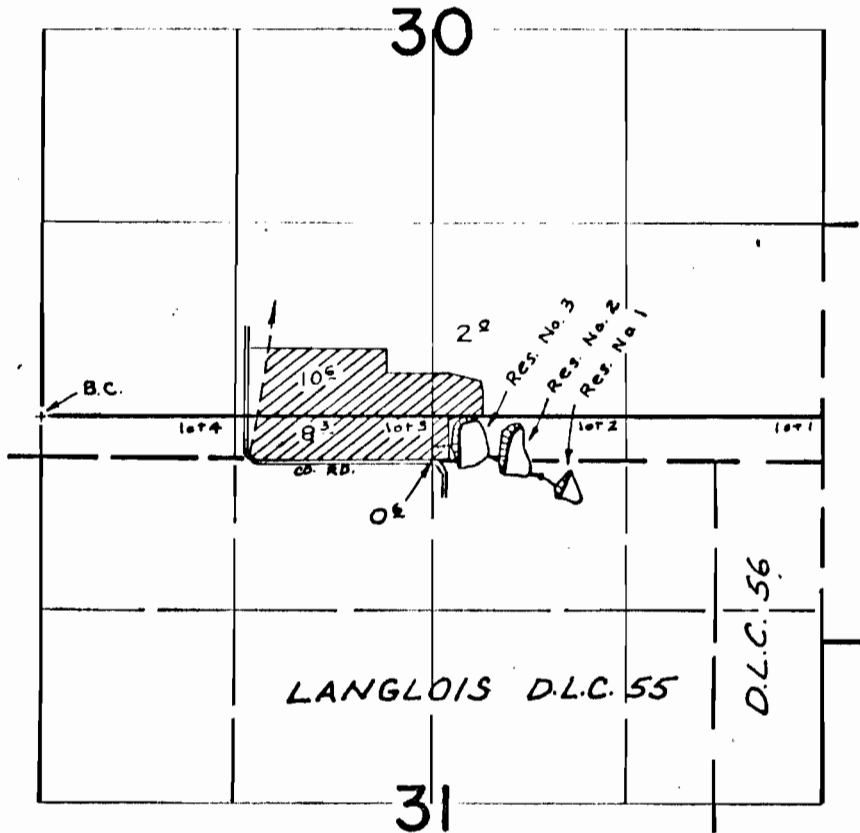

DIV. PTS. LOC: RES. #1- 470'S & 3500'E; RES. #2- 200'S & 3100'E ; RES. #3- 200'S & 2800'E, ALL FROM N.W. COR. SEC. 31

FINAL PROOF SURVEY UNDER

Application No. ^{R-46674} 46675... Permit No. ^{R-5577} 34870...
IN NAME OF

EVANS...VALLEY...LAND...&...LIVESTOCK...CO.

Surveyed MAY 13, 1964, by R. JACKSON.
JUNE 5, 1973 R. MUCKEN