

T.6S. R.8W. W.M.

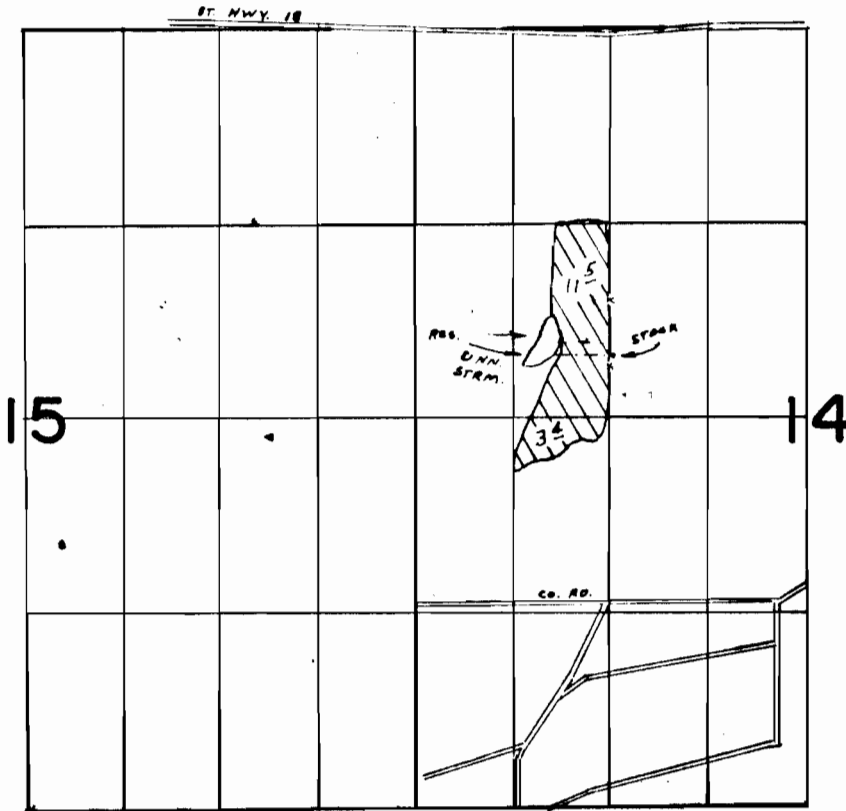

Dam Loc. 900' S & 360' W From NE Cor. SW 1/4,
NW 1/4, Sec. 14, T.6 S, R.8 W, W.M.

FINAL PROOF SURVEY UNDER

Application No. ^{R-44536} 44537... Permit No. ^{R-5274} 33224...
IN NAME OF

.....HARRY.....DITMORE.....

Surveyed Jul. 18... 1974, by L. H. NUNN.....