

T.6S. R.8W. W.M.

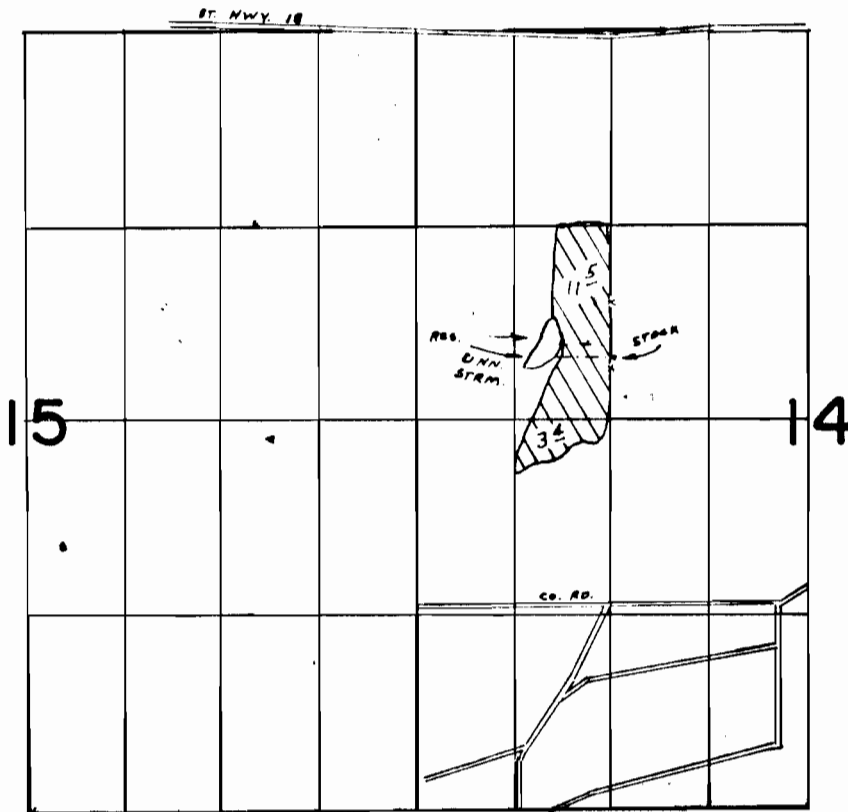

Dam Loc. 900' S & 360' W From NE Cor. SW 1/4,
NW 1/4, Sec. 14, T. 6 S., R. 8 W., W. M.

FINAL PROOF SURVEY UNDER

Application No. ^{R-44536} 44537 Permit No. ^{R-5274} 33224
IN NAME OF

..... HARRY DITMORE

Surveyed Jul. 18, 1974, by L. H. NUNN