

T.4S. R.3W. W.M.

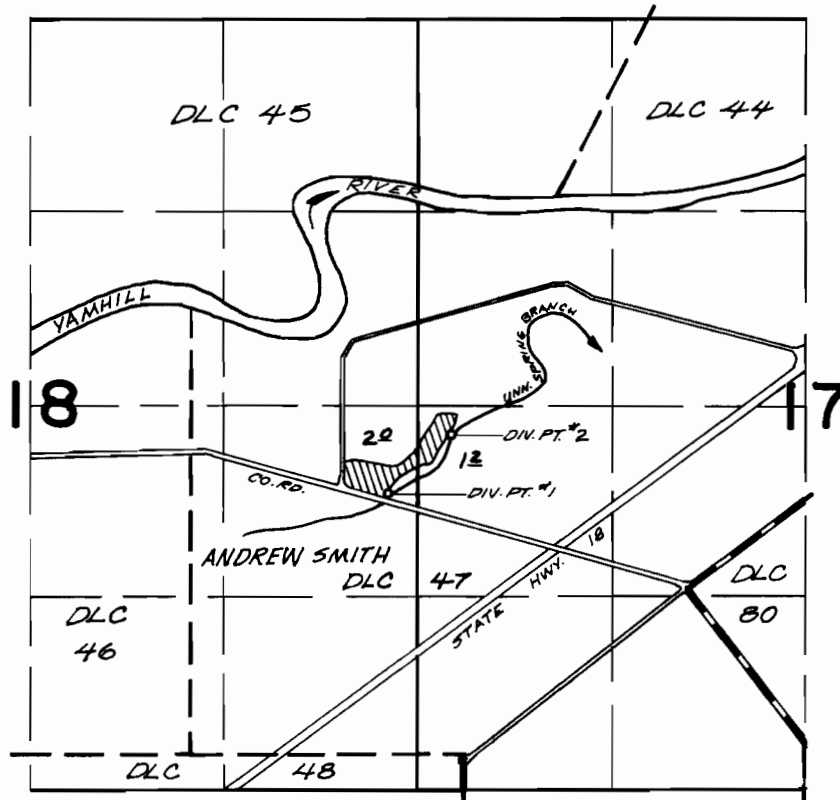

DIV. PT.#1; 1780' N., 500' W.; DIV. PT.#2; 2180' N., 80' W.;
BOTH FROM THE W'LY INT. "L" OF ANDREW SMITH DLC 47

FINAL PROOF SURVEY UNDER

Application No. 47220 Permit No. 35373
IN NAME OF

IRVIN R. REINHARD

Surveyed JUNE 12 1974, by L.M. TOLL