

T.13S., R.6W., W.M.

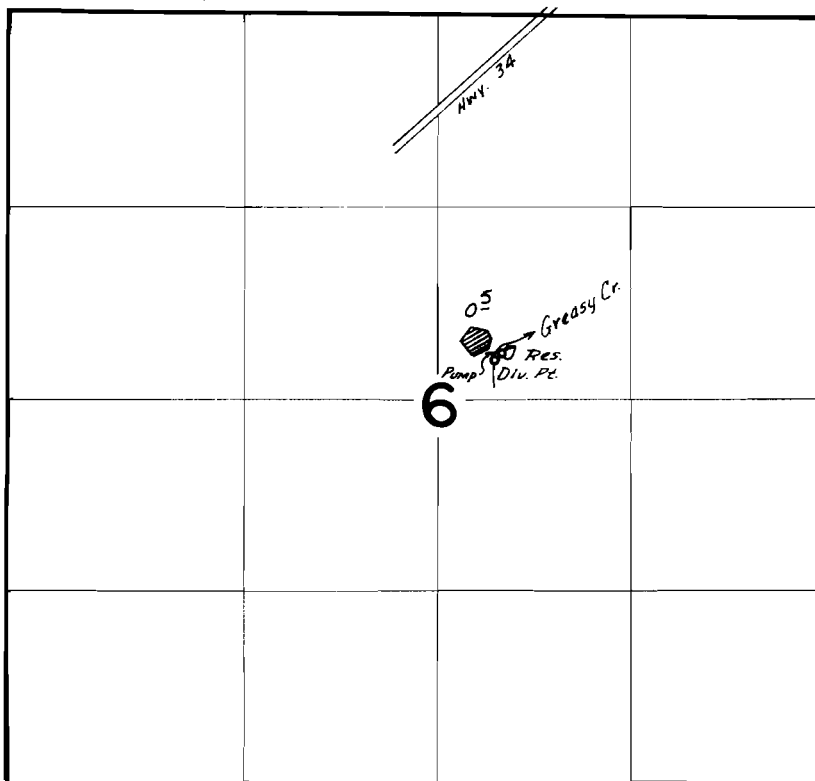

DIV. PT. LOC.: CR. - 2370'S & 390'E; RES. - 2280'S & 470'E BOTH FROM N 1/4 COR. SEC. 6.

FINAL PROOF SURVEY
UNDER

R-50764 R-5972
Application No. 50765 Permit No. 36801
IN NAME OF

MILTON E. ROWLAND

Surveyed Aug. 15 1975, by D. Norby