

T.4S., R.1E., W.M.

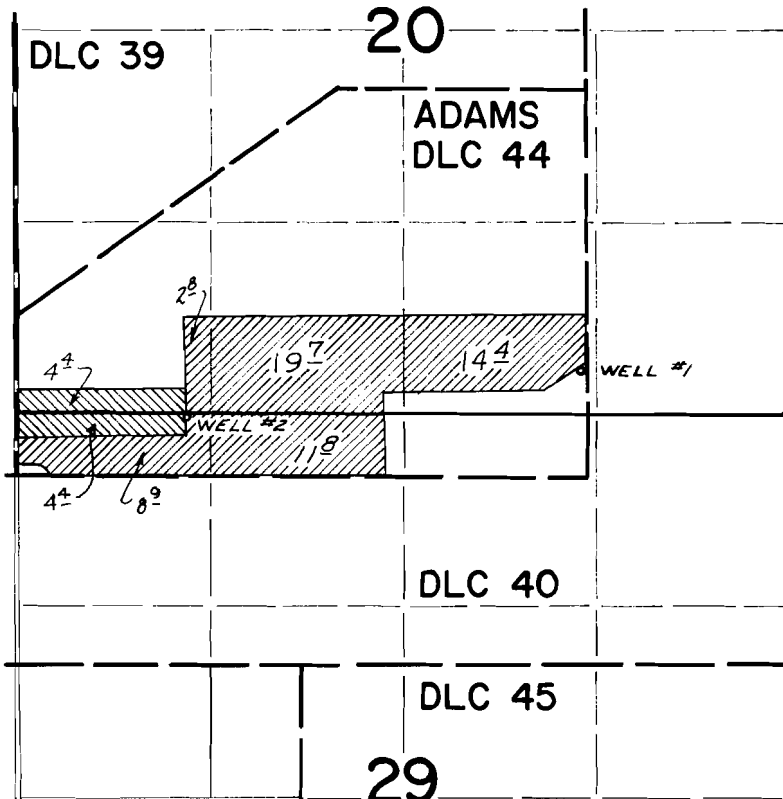

WELLS LOCATED: #1 - 740' N & 40' W, #2 - 400' N & 2740' W, BOTH FROM SE COR ADAMS DLC 44.



FINAL PROOF SURVEY UNDER

Application No. G-3967 Permit No. G-3725
IN NAME OF

JOSEPH E. AND FRANCES L. BRONEC

Surveyed Sept. 19 1974, by [Signature]