

T.3 & 4 S. R.I.E. W.M.

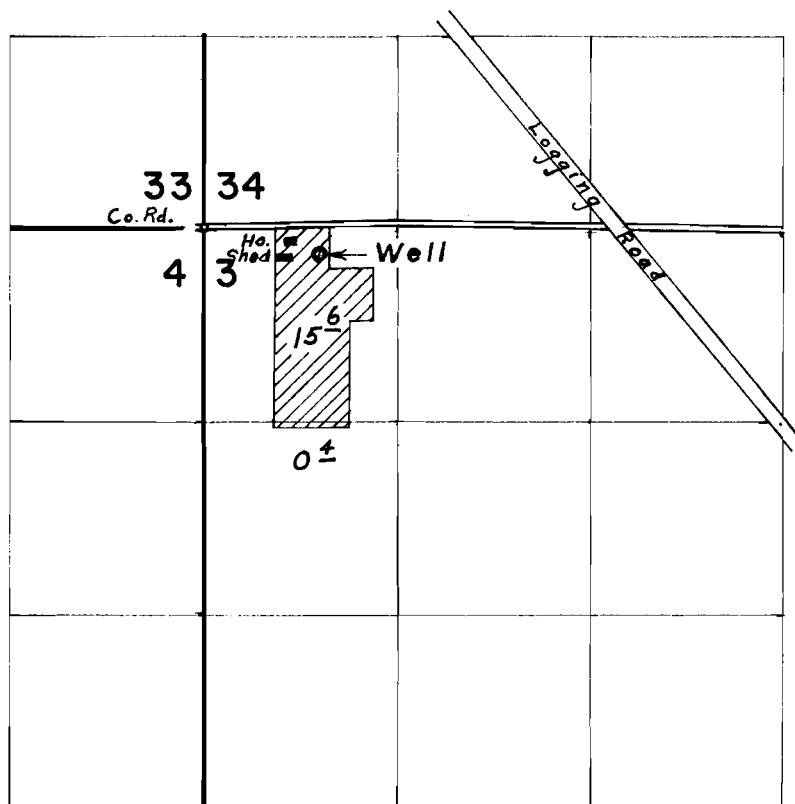

Well located 180' S. & 790' E. from N.W. Cor. Sec. 3

FINAL PROOF SURVEY

UNDER

Application No. G-5310 Permit No. G-5136

IN NAME OF

ARTHUR A. WRIGHT

Surveyed May 8, 1975, by L. E. Gould