

RECEIVED

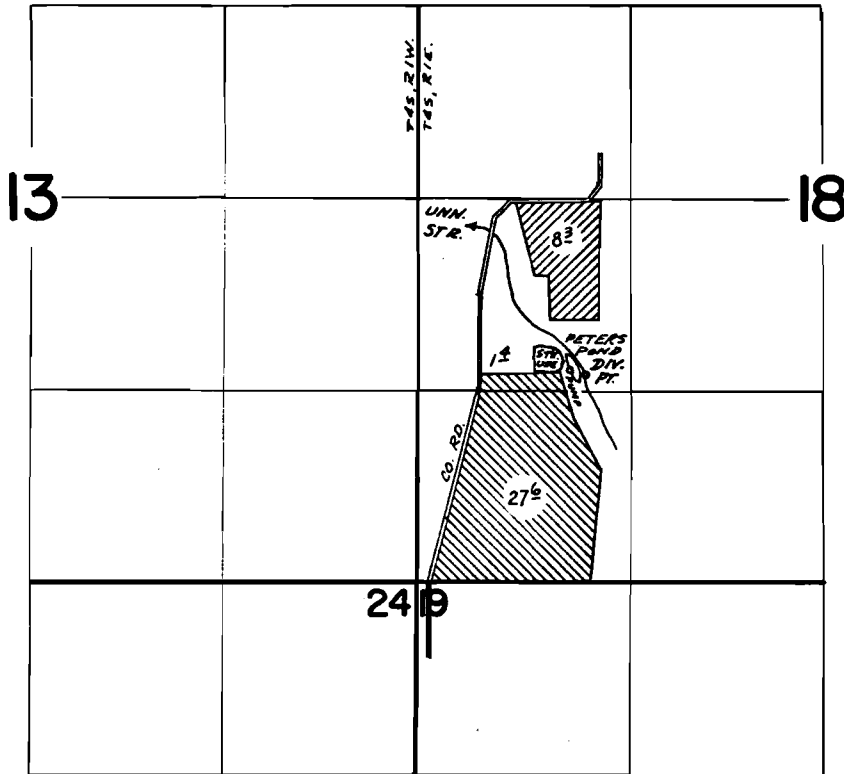

FEB 17 1977

WATER RESOURCES DEPT
EM, OREGON

T.4S., R.1E., W.M.



DIV. PT. LOCATED: 1420' N & 1150' E FROM SW COR. SEC. 18.
POND LOCATED: 1450' N & 1040' E FROM SW COR. SEC. 18.

-  PRIMARY STREAM & RESEVOIR
-  SUPPLEMENTAL RESERVOIR ONLY

FINAL PROOF SURVEY
UNDER

R-48517

R-5891

Application No. 48518 Permit No. 36402

IN NAME OF

L. R. PETERS

Surveyed Sept. 6 1974, by D. J. Jorby

Application No. 55269
Permit No. 44141