

T. 25 S. R. 12 & 13 W. W. M.

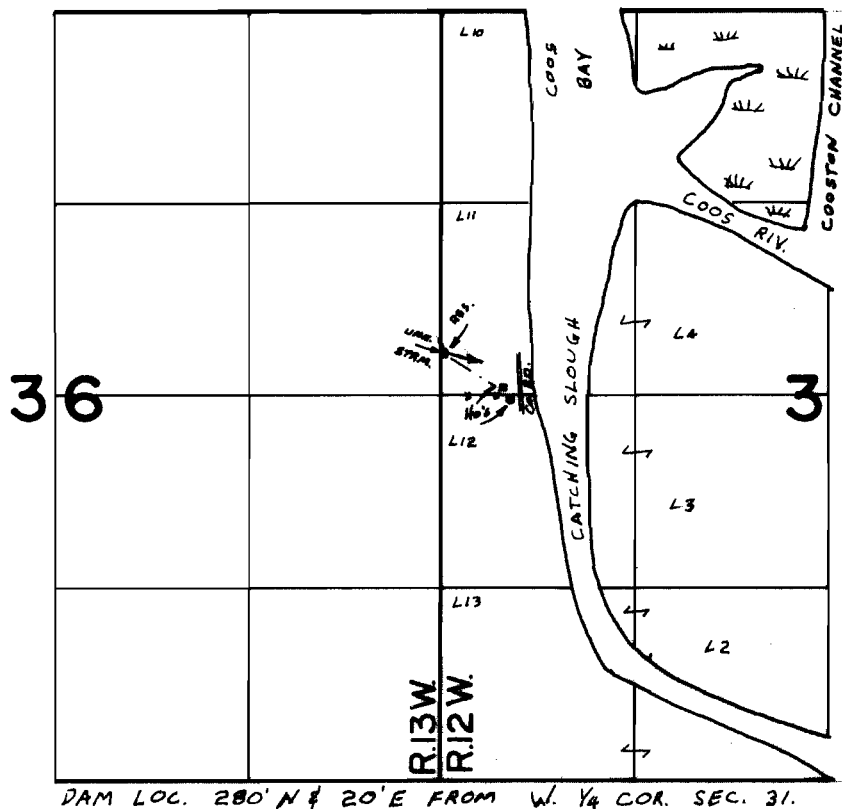

DAM LOC. 280' N & 20' E FROM W. 1/4 COR. SEC. 31.

FINAL PROOF SURVEY
UNDER

R-48659 R-5901

Application No. 48660 Permit No. 36494
IN NAME OF

WARREN T. BRAINARD

Surveyed JUL 24 1974, by LH NUNN