

T.35S. R.6&7W. W.M.

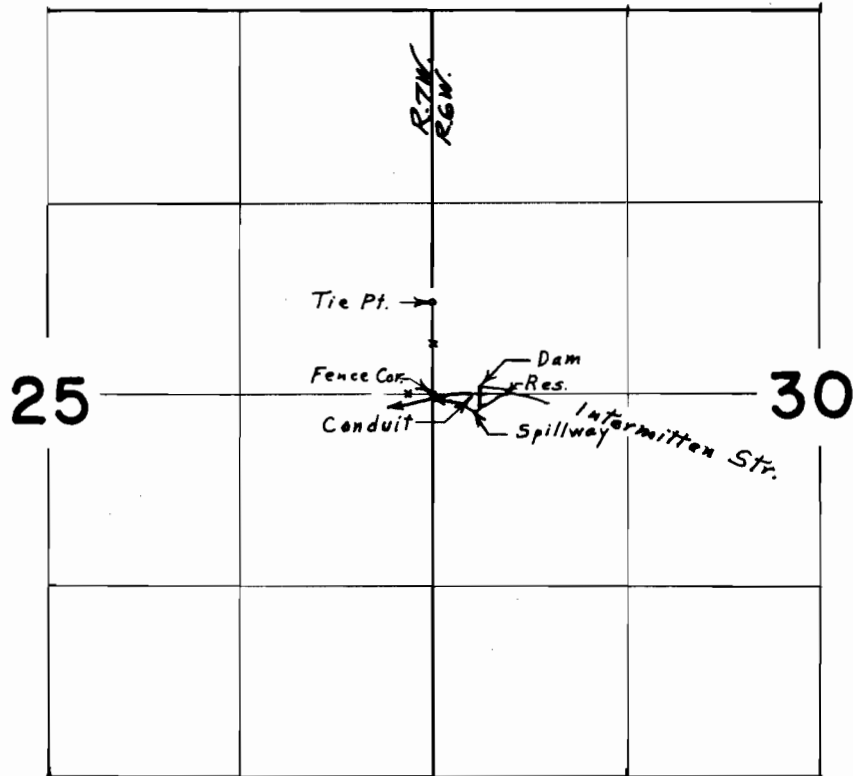

Div. Pt. located 330' E. & 10' S. from W. $\frac{1}{4}$ Cor. Sec. 30

FINAL PROOF SURVEY
UNDER

Application No. R-48356 Permit No. R-5751
IN NAME OF

CARL WILLIAM REINHARDT

Surveyed April 16, 1974, by L. E. Gould