

T.6S. R.6W. W.M.

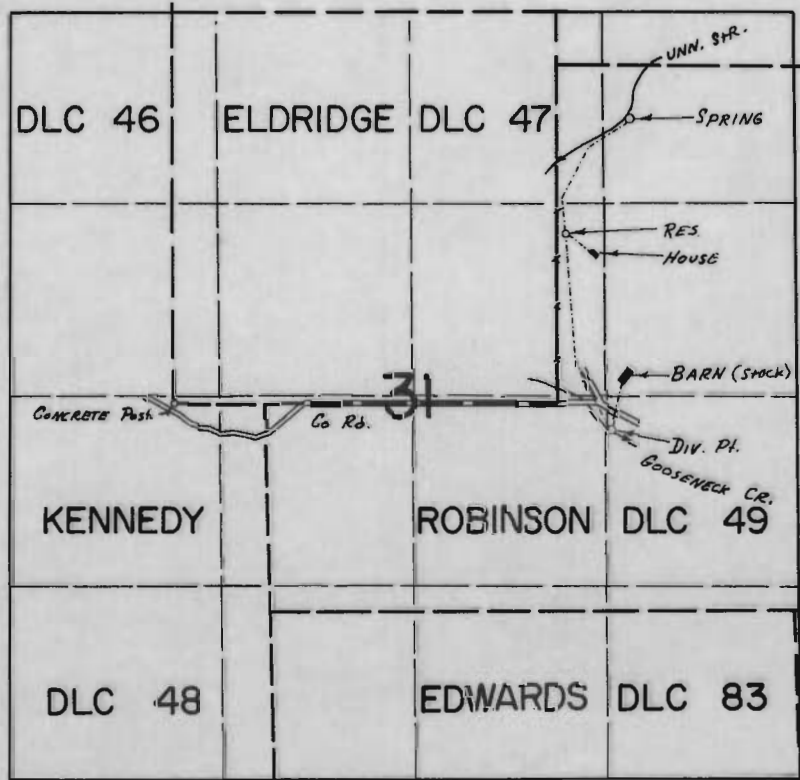

SPRING Loc 1970' N & 500' E; DIV. Loc 190' S & 350' E BOTH FROM SE COR ELDRIDGE DLC 47

**FINAL PROOF SURVEY**  
UNDER

Application No. 49427... Permit No. 37023...  
IN NAME OF

GEORGE H. BITTNER

Surveyed April 22 1974, by T. J. PAUL