

T.16S. R.2E. W.M.

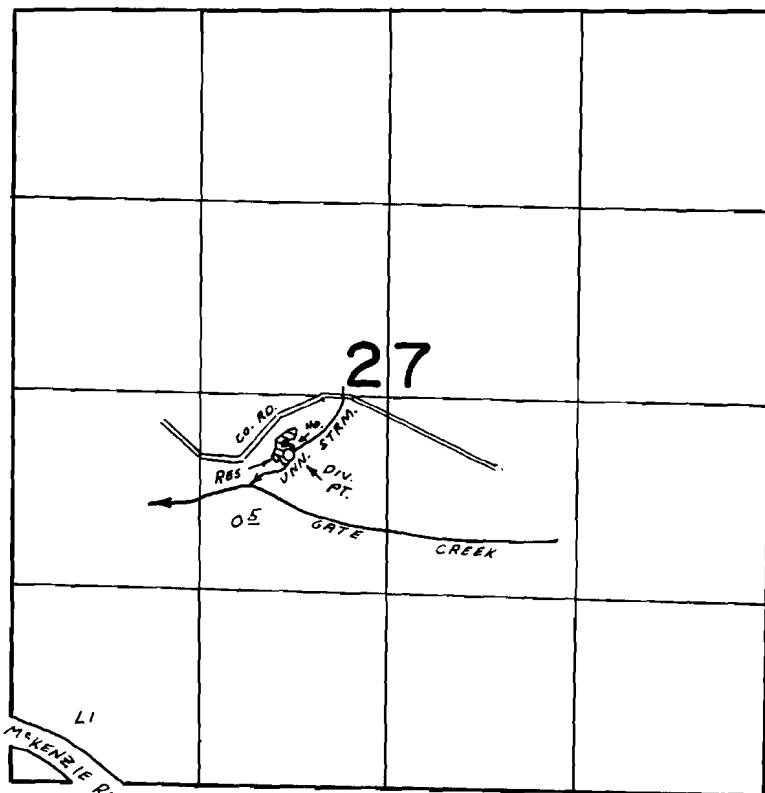

DIV. PTS. LOC: STR-390' S & 670' W, RES. - 410' S & 760' S,
BOTH FROM THE CENTER, SECTION 27

FINAL PROOF SURVEY UNDER

R-48506 R-5814
Application No. 48507 Permit No. 35964...
IN NAME OF

ROBERT M. ROBERTSON

Surveyed AUG 22 1974, by L.H. NUNN