

# T.16S. R.2E. W.M.

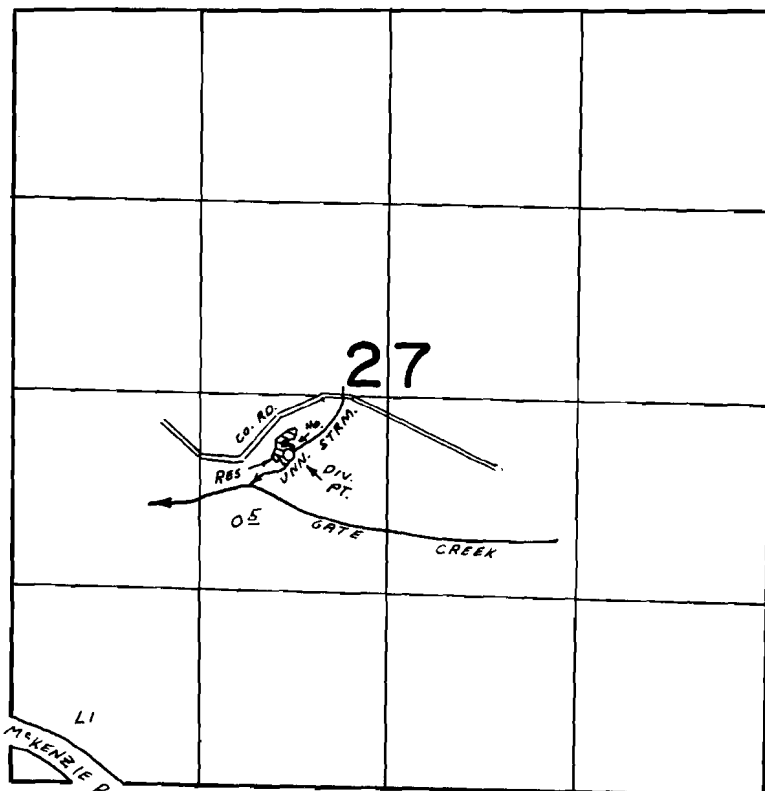

DIV. PTS. LOC: STR-390' S & 670' W, RES. - 410' S & 760' S,  
BOTH FROM THE CENTER, SECTION 27

## FINAL PROOF SURVEY UNDER

R-48506                      R-5814  
Application No. 48507    Permit No. 35964...  
IN NAME OF

ROBERT M. ROBERTSON

Surveyed AUG 22 1974, by L.H. NUNN