

T.4 S. R.1 & 2 E. W.M.

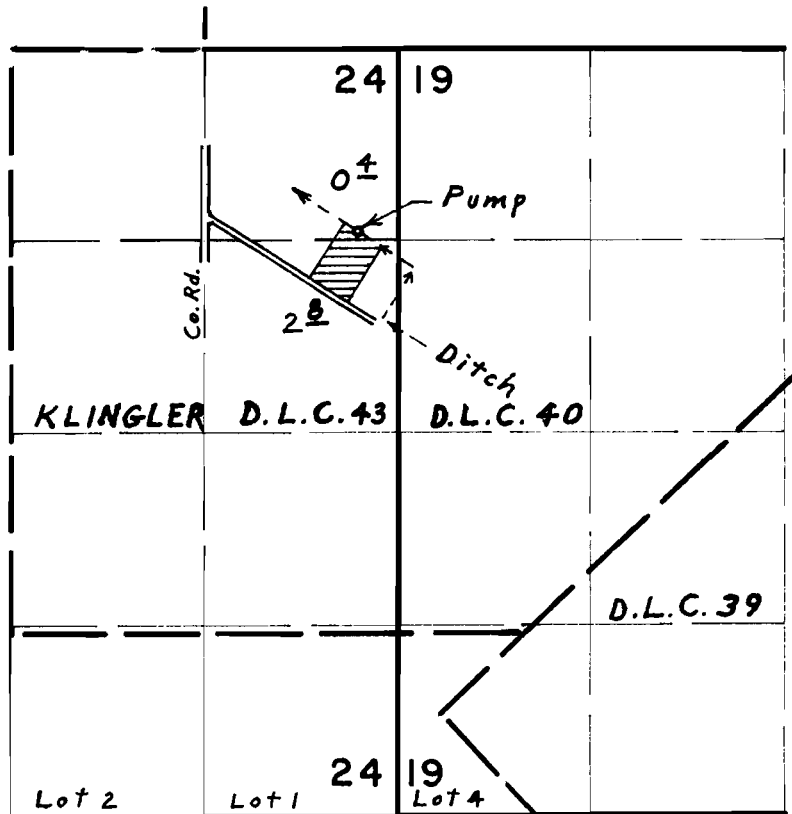

Div. Pt. located 1390' S. & 850' E. from N. E. Corner
 Wright D.L.C. 39, S. 15 T. 58. R. 2 E. W. M.

FINAL PROOF SURVEY

UNDER

Application No. 48693 Permit No. 35816

IN NAME OF

WALTER E. & FRANCES J. BOWEN

Surveyed May 8, 1975, by L. E. Gould