

T.29S.,R.6W.,W.M.

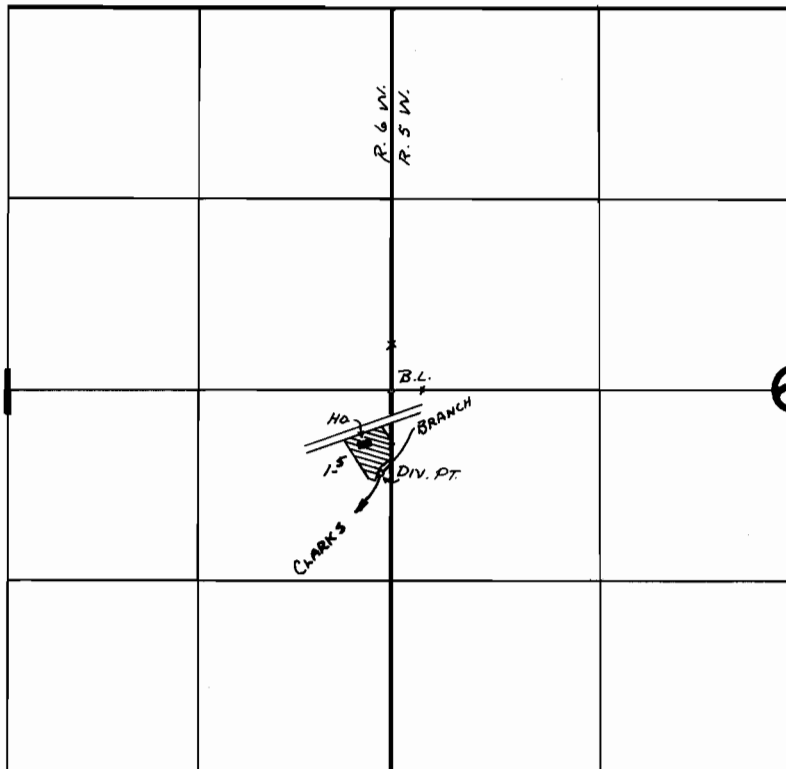

DIV. LOC: 570' S AND 80' W FROM E 1/4 COR SEC 1

**FINAL PROOF SURVEY**  
UNDER

Application No. 47045 Permit No. 35187  
IN NAME OF

EDWARD J. KENNY

Surveyed July 25 1975, by L. E. GOULD