

T.27S., R.3W., W.M.

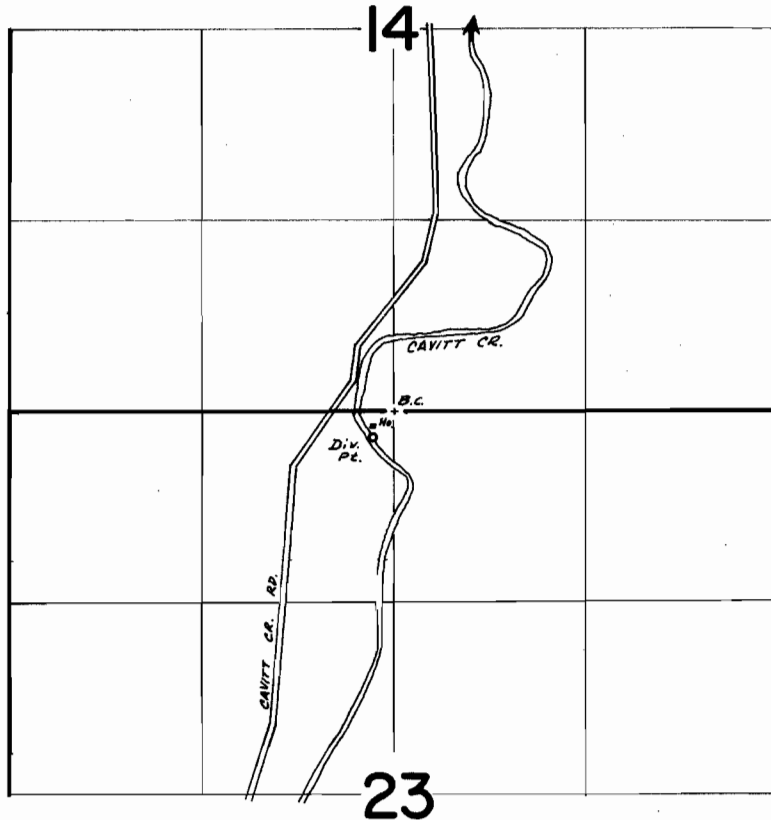

DIV. PT. 180' S. & 140' W. FROM N. 1/4 COR. SEC. 23

FINAL PROOF SURVEY
UNDER

Application No. 49270 Permit No. 36926
IN NAME OF
DOUGLAS L. AND YVONNE MENTZER
Surveyed Nov. 5 1975, by D. Norby