

# T.33S. R.6W. W.M.

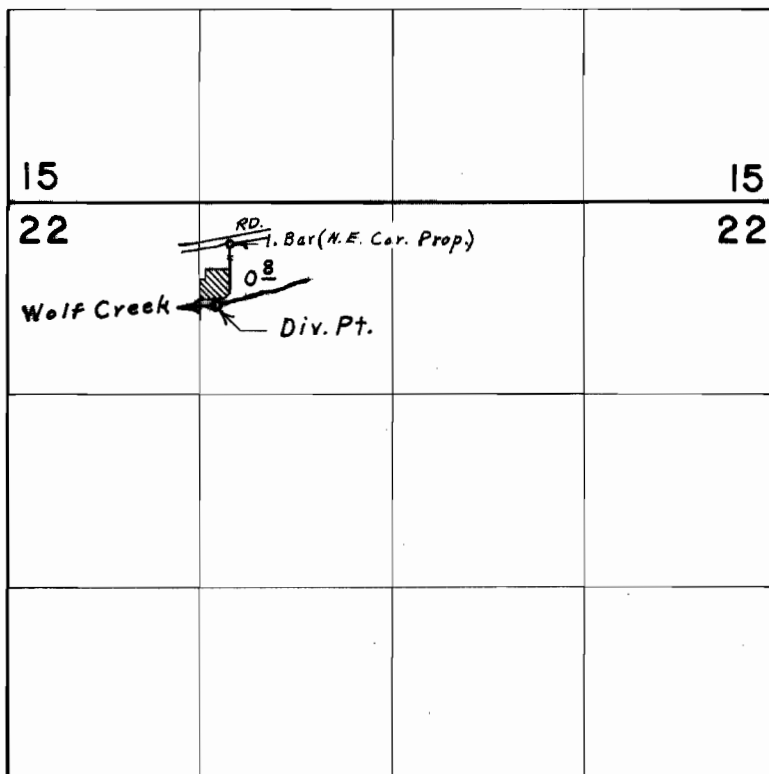

*Div. Pt. located 700' S. & 1428' E. from N.W. Cor. Sec. 22*

## FINAL PROOF SURVEY UNDER

Application No. 39668 Permit No. 29530  
IN NAME OF

CHARLES & AGNESS MERRILL

Surveyed May 13, 1974, by L. E. Gould