

T.5 S. R.5 W. W.M.

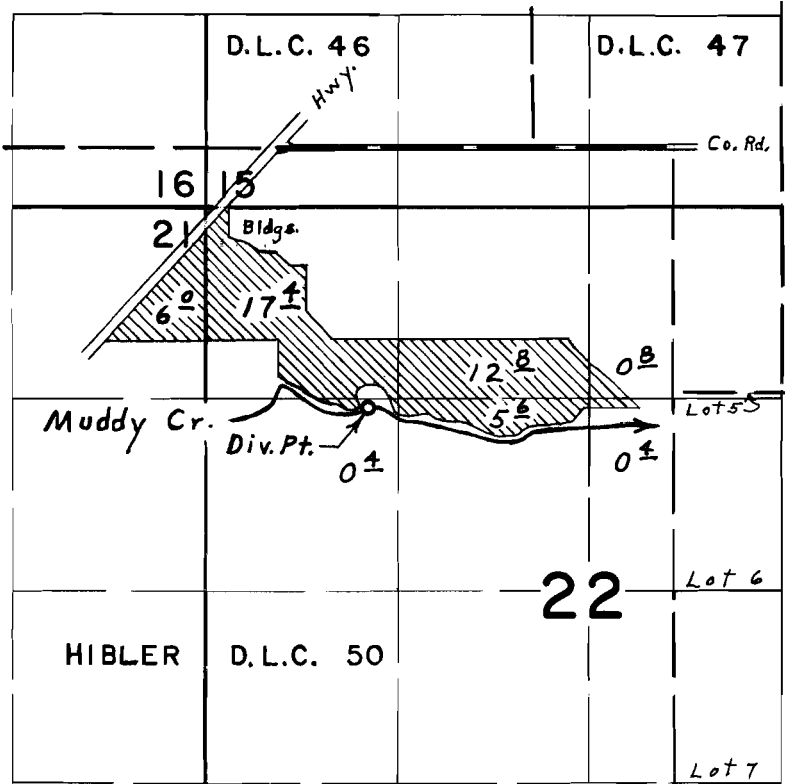

Div. Pt. loc. 1780' S. & 2090' W. from N. E. Cor. Hibler D.L.C. 50

FINAL PROOF SURVEY UNDER

Application No. 46311 Permit No. 34603
IN NAME OF

JAMES L. DUYCK

Surveyed Sept. 3, 1975 by L. E. Gould