

T. 33S.R.2E.W.M.

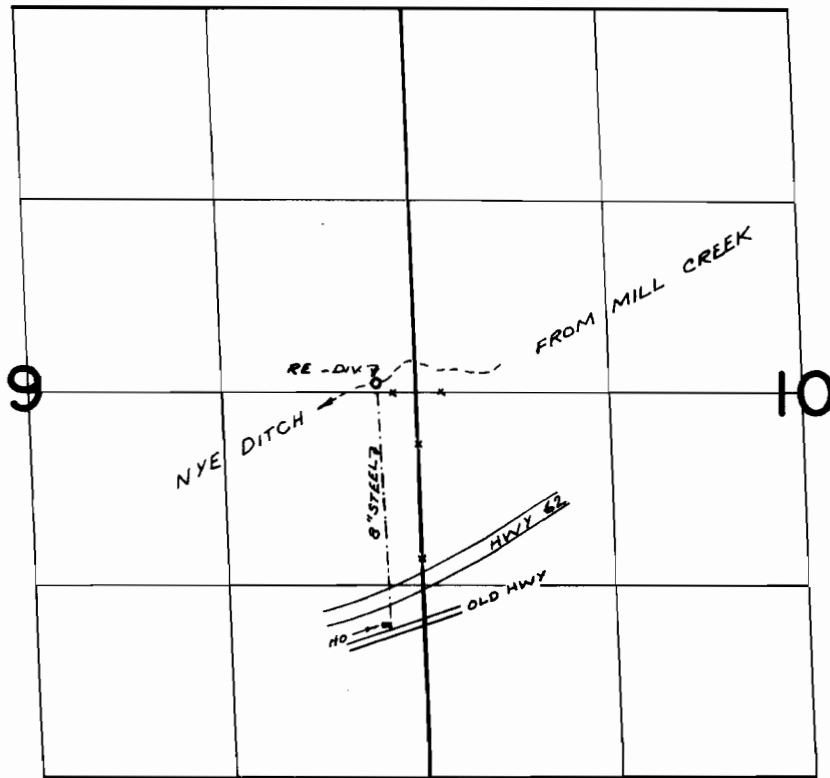

DIV. PT. LOC: 1860' N. & 2690' E FROM S.W. COR. SEC. 28,
T. 32 S. R. 3 E. W. M.

FINAL PROOF SURVEY
UNDER

Application No. ~~47946~~ Permit No. ~~35948~~
IN NAME OF

.....JOHN G. & LAURA L. LANGLEY.....

Surveyed JUNE 12, 1974, by R. MUCKEN