

T.12S., R.3W., W.M.

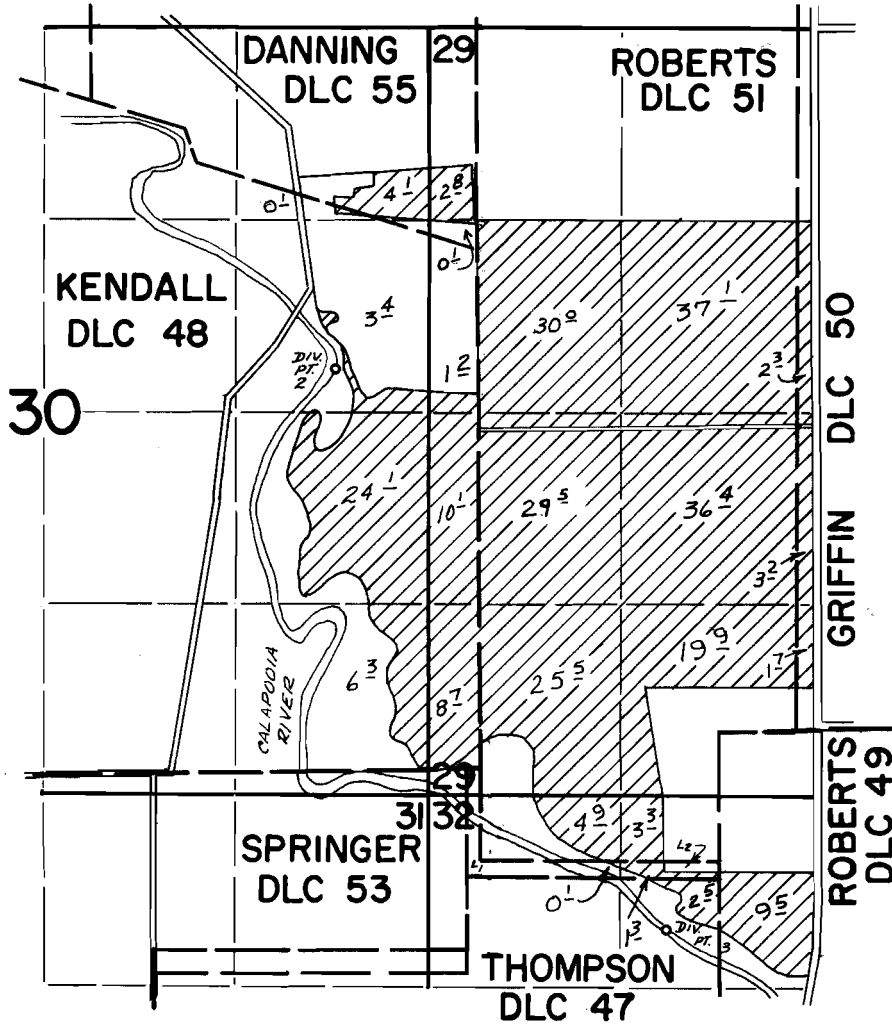

DIV. PTS. LOCATED: 2 - 820' S & 940' W FROM NE COR. KENDALL DLC 48
 3 - 910' S & 1030' W FROM N/4 COR. SEC. 32.

FINAL PROOF SURVEY UNDER

Application No. 44354 Permit No. 33115
 IN NAME OF

WIRTH FARMS

Surveyed Nov. 5 1974, by D.M. Norby