

T.11S., R.3W., W.M.

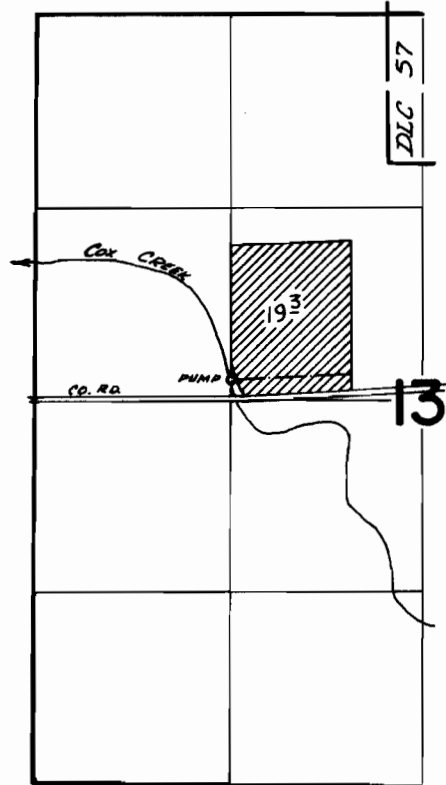

T.12S., R.1W., W.M.

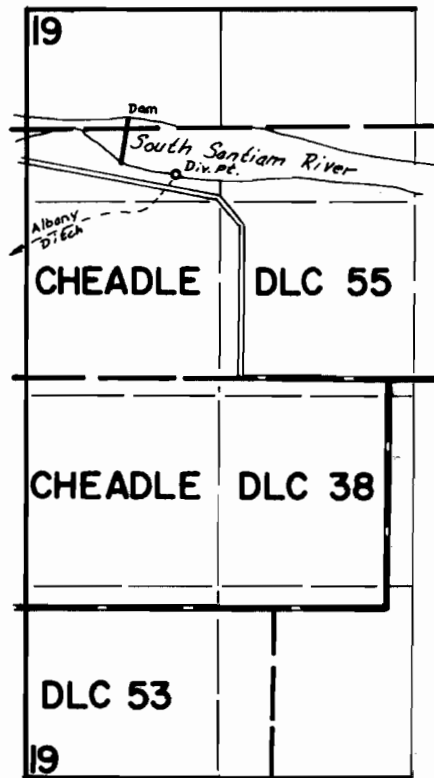

DIV. PT. LOCATED: 1400' N & 1360' W  
FROM NE COR CHEADLE DLC 38.

**FINAL PROOF SURVEY**  
UNDER

Application No. 48040 Permit No. 36025  
IN NAME OF

GRAND PRAIRIE WATER CONTROL DISTRICT

Surveyed May 3 1974, by D.M. Norby