

T.1S.R.9W.W.M.

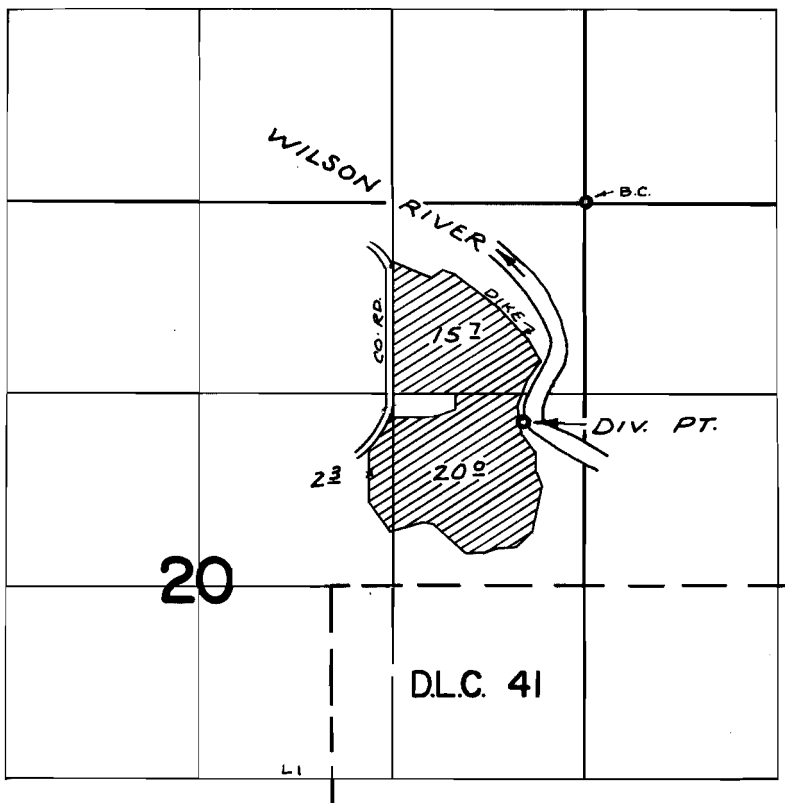

DIV. PT. LOC: 1500'S. & 420'W. FROM N.E. COR. SEC. 20

FINAL PROOF SURVEY UNDER

Application No. 43446 Permit No. 32903
IN NAME OF

HANS A. TANNER

Surveyed SEPT. 10, 1974, by R. MUCKEN