

T.33S.R.2E.W.M.

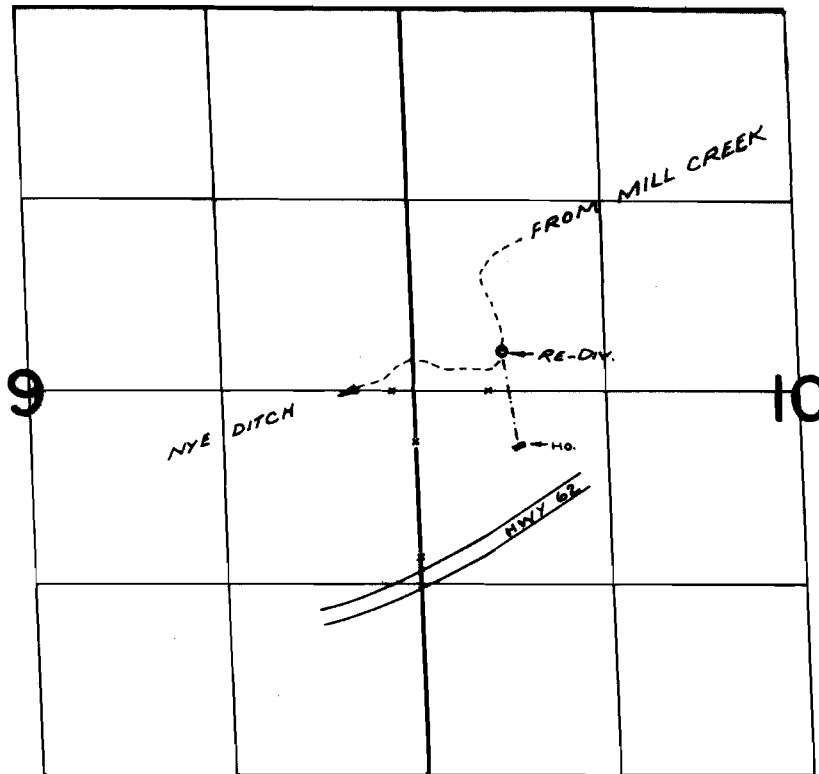

DIV. PT. LOC: 1860' N. E 2690' E. FROM S.W. COR. SEC. 28.
T. 32 S. R. 3 E. W. M.

FINAL PROOF SURVEY UNDER

Application No. 42171..... Permit No. 31559..
IN NAME OF

.....MRS. LLOYD E. HALE.....

Surveyed JUNE 13, 1974., by R. MUGKEN