

T.I.S., R.I.W., W.M.

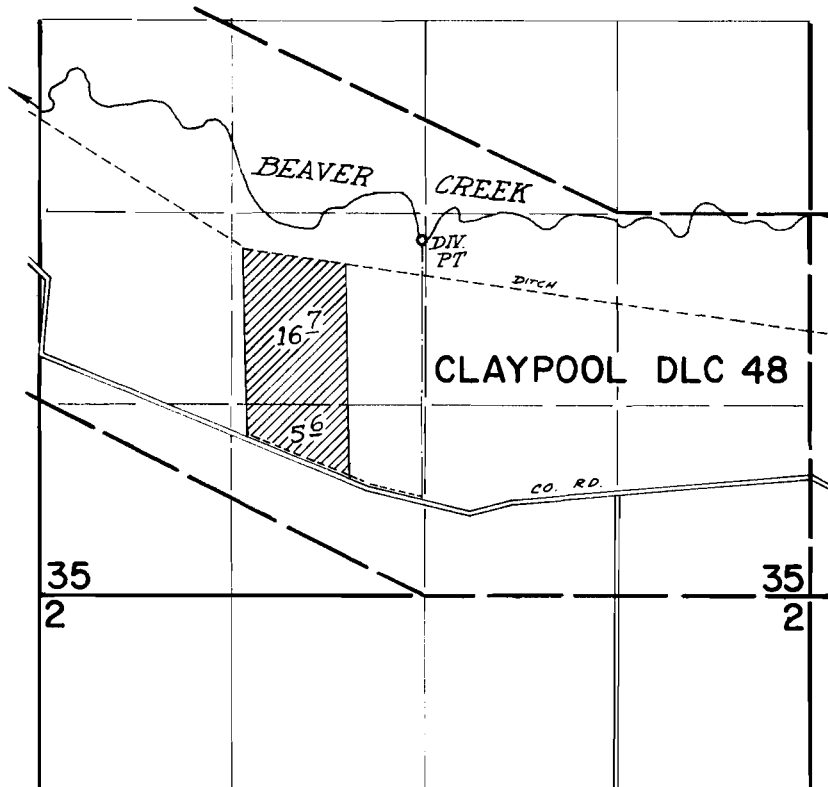

DIV. PT. LOCATED: 2440' N & 2660' W FROM SE COR SEC 35.

FINAL PROOF SURVEY UNDER

Application No. 47251 Permit No. 35392
IN NAME OF

MARVIN D. DEPUE

Surveyed Nov. 4 1974, by D.M. Norby