

T.33S.R.2E.W.M.

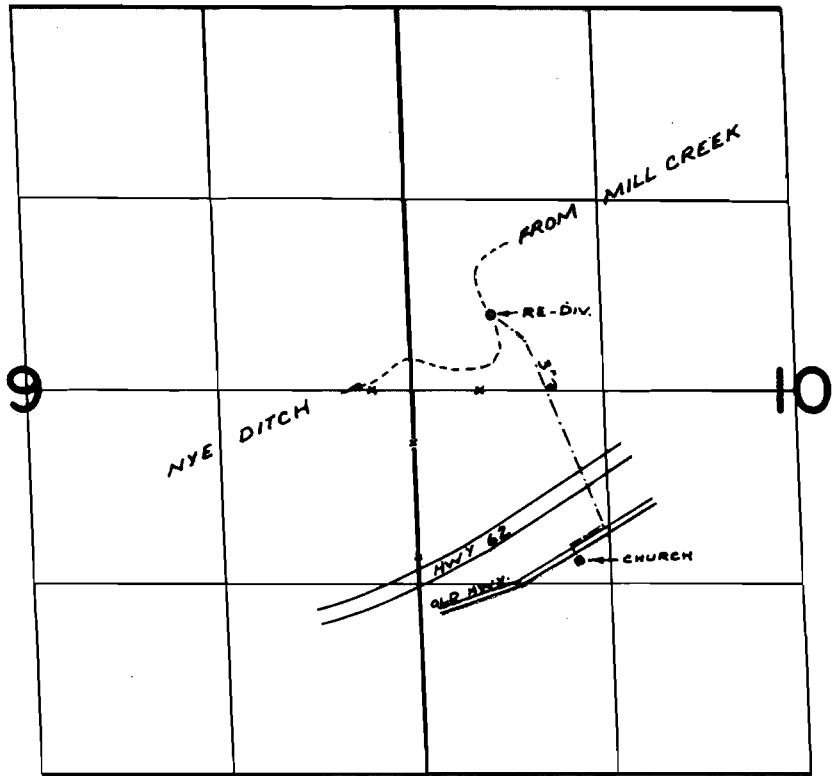

DIV. PT. LOC: 1860'N & 2690'E. FROM S.W. COR. SEC. 28,
T. 32 S. R. 3 E. W. M.

FINAL PROOF SURVEY
UNDER

Application No. 41246..... Permit No. 31460.....
IN NAME OF

CASCADE GORGE COMMUNITY CHRISTIAN CHURCH

Surveyed JUNE 13, 1974., by R. MURKIN