

T.15S. R.4W. W.M.

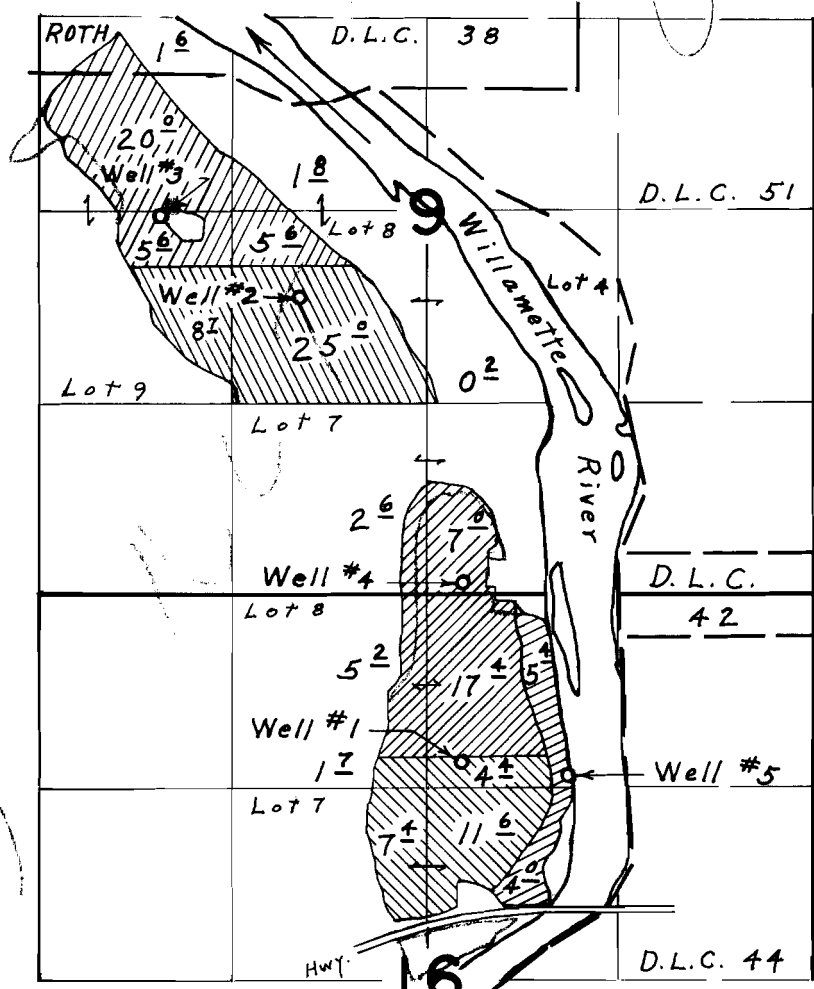

Wells located: #1, 1160' S. & 240' E.; #2, 2040' N. & 870' W.; #3 2610' N. & 1830' W.; #4, 80' N. & 250' E.; #5, 1250' S. & 970' E.; all from $\frac{1}{4}$ Cor. Common To Secs. 9 & 16

FINAL PROOF SURVEY UNDER

- From Well #1
- From Well #2
- From Well #3
- From Well #4
- From Well #5

Application No. G-5317 Permit No. G-5142
IN NAME OF
E. B. SPLAWN

Surveyed July 26, 1974, by L. E. Gould