

T.8S., R.5W., W.M.

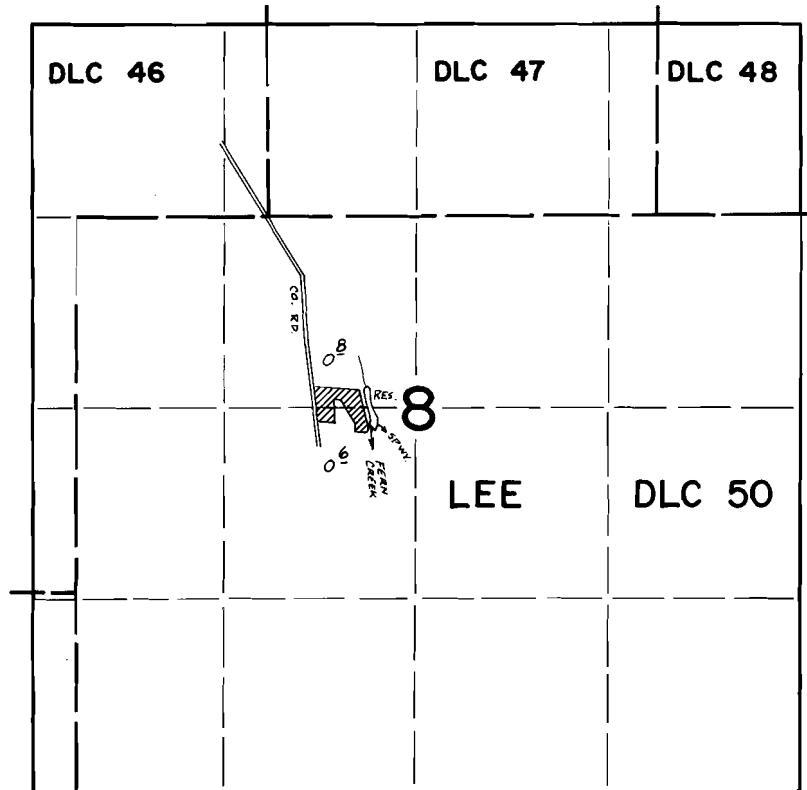

RES. LOC: 1450'S & 2030'E FROM NW COR. LEE DLC 50

FINAL PROOF SURVEY UNDER

R-47701 R-5759
Application No. 47702 Permit No. 35735
IN NAME OF

HERBERT R. AND MARGARET McBEE

Surveyed June 13, 1975, by D. Norby