

T.8S., R.5W., W.M.

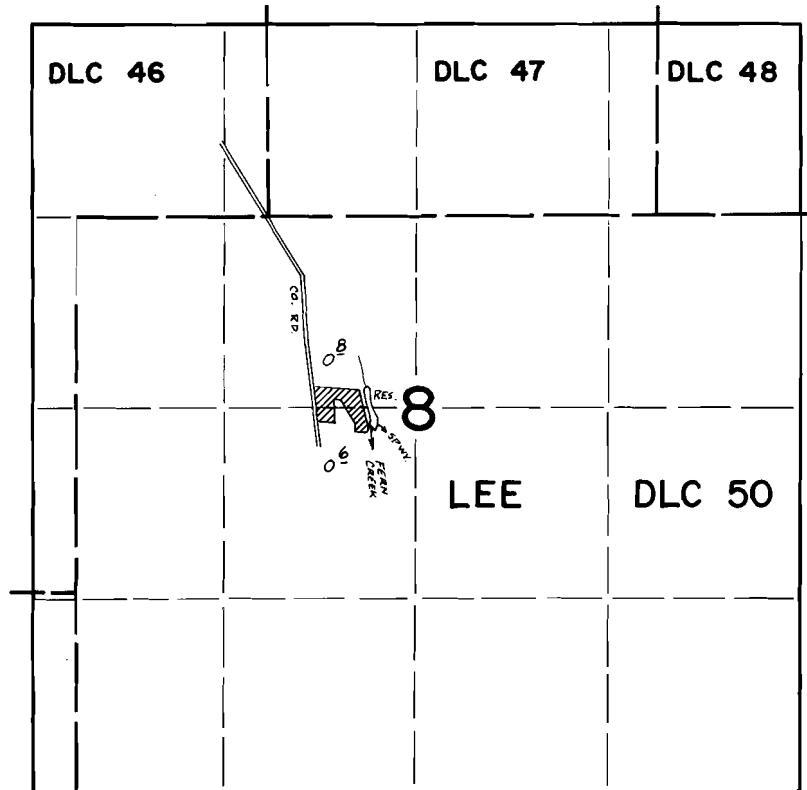

RES. LOC: 1450'S & 2030'E FROM NW COR. LEE DLC 50

**FINAL PROOF SURVEY**  
UNDER

R-47701                      R-5759  
Application No. 47702      Permit No. 35735  
IN NAME OF

HERBERT R. AND MARGARET McBEE

Surveyed June 13 1975, by D. Norby