

T.3S.R.9W.W.M.

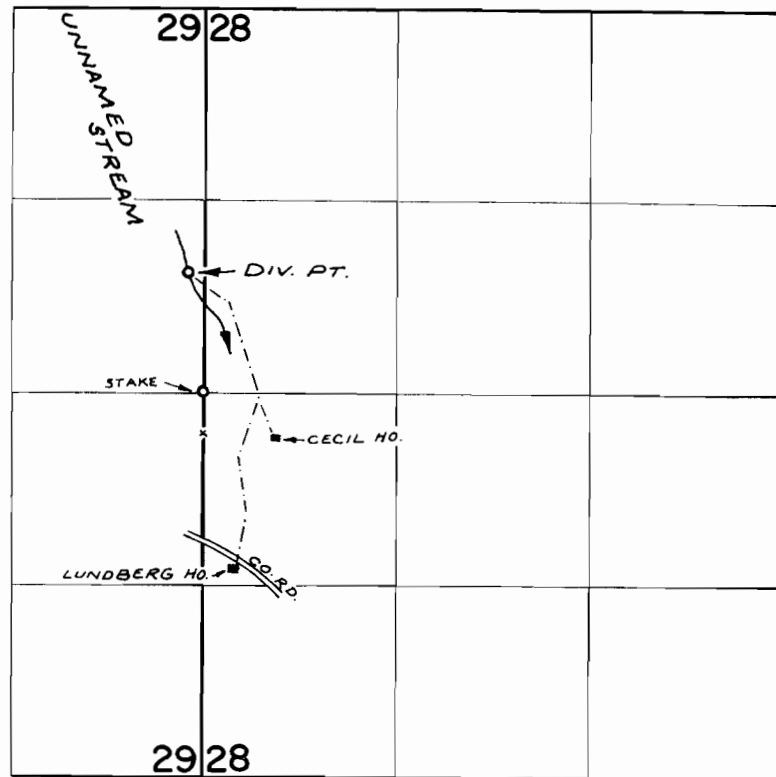

DIV. PT. LOC: 830' N. & 100' W. FROM E  $\frac{1}{4}$  COR. SEC. 29

**FINAL PROOF SURVEY**  
UNDER

Application No. 46978 Permit No. 35148

IN NAME OF

KENNETH W. CECIL &  
ELMER & MABEL LUNDBERG

Surveyed SEPT. 13, 1974, by R. MUCKEN