

T.2S. R.1W. W.M.

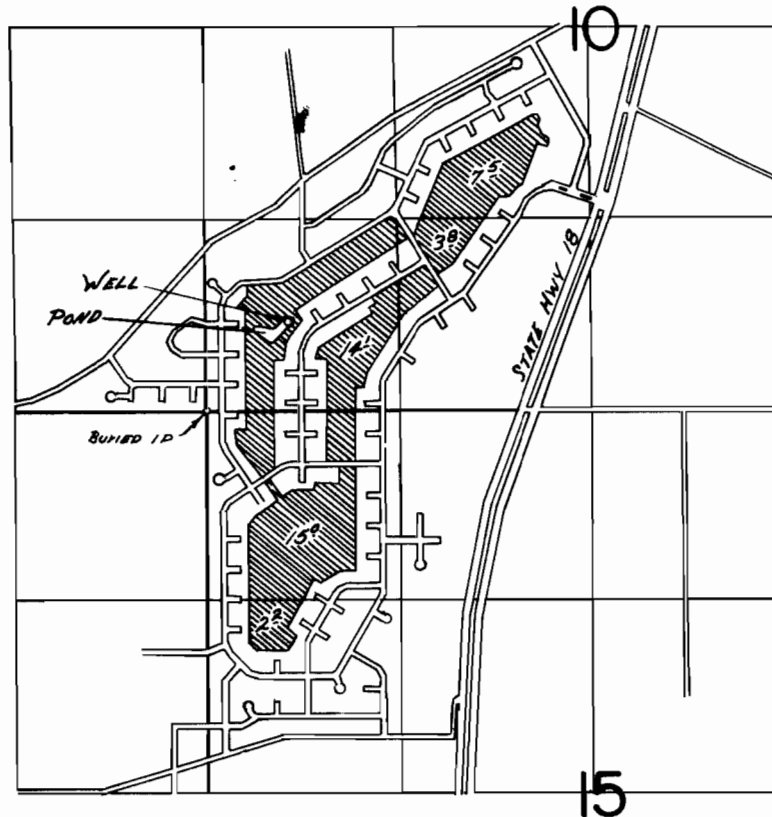

WELL LOC. 610' N & 570' E FROM SW COR SEC 10.

**FINAL PROOF SURVEY**  
UNDER

Application No. G-3777.. Permit No. G-3463..  
IN NAME OF

KING CITY CIVIC ASSOCIATION.....

Surveyed MAY...13. 1974, by R.G. MUCKEN