

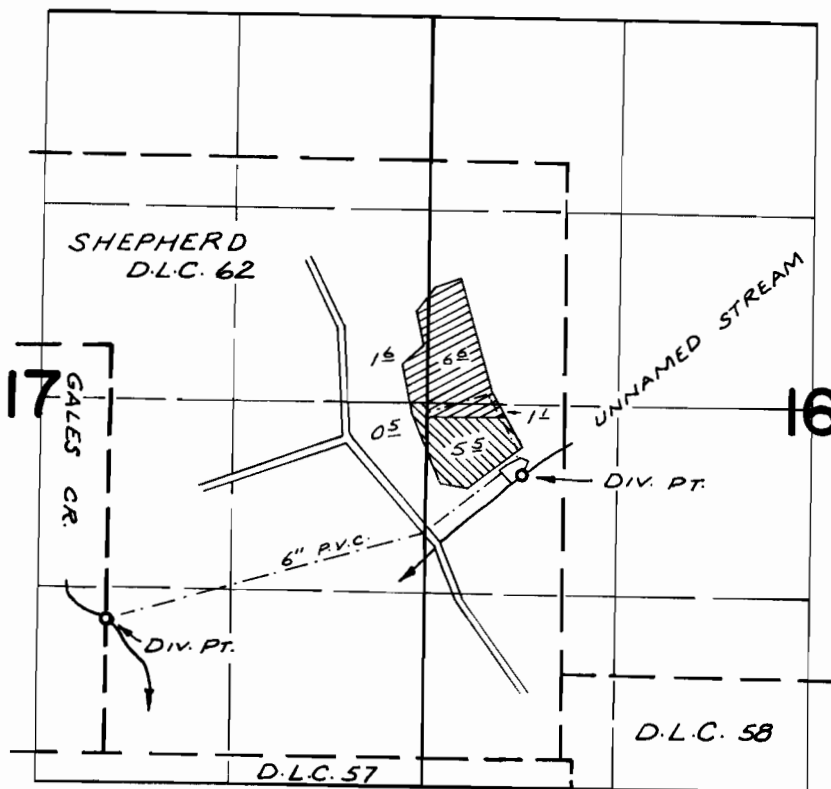

T.1N.R.4W.W.M.



DIV. PTS. LOC: GALES CR. - 3180'S. & 3110'W; UNNAMED STREAM - 2150'S. & 280'W, BOTH FROM N.E. COR. D.L.C. 62

 SUPPLEMENTAL GALES CR.

 PRIMARY UNNAME STREAM & RESERVOIR

FINAL PROOF SURVEY UNDER

Application No. 46984 Permit No. 35154
IN NAME OF

PAUL J. CHOBAN

Surveyed NOV. 7, 1974, by R. MUCKEN