

T.26S., R.12W., W.M.

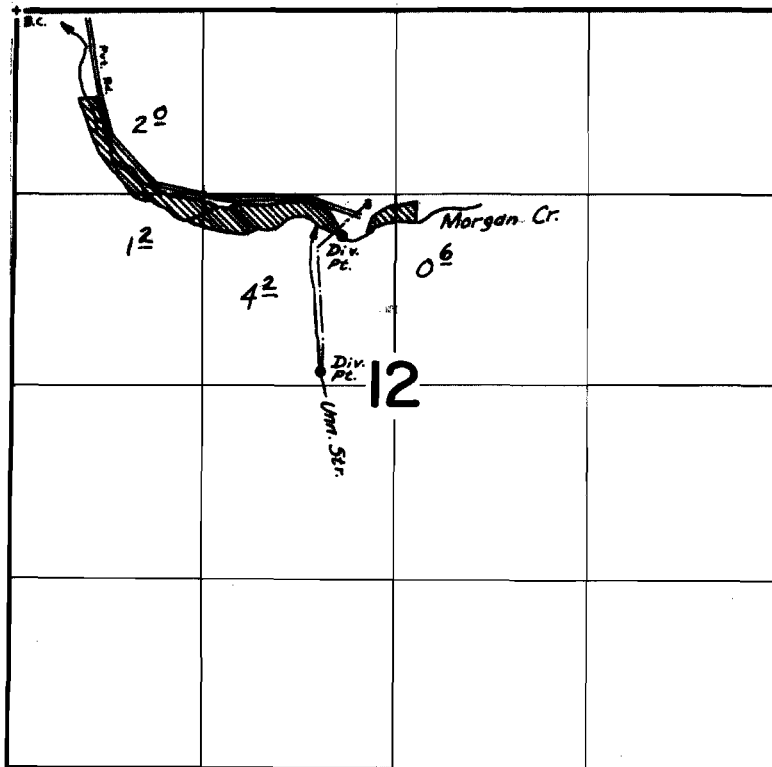

DIV. PTS. LOC: UNN. STR. - 2480'S & 2110'E; MORGAN CR. - 1550'S & 2240'E  
BOTH FROM NW COR. SEC. 12

**FINAL PROOF SURVEY**  
UNDER

Application No. 44077 Permit No. 32991  
44078 32992  
IN NAME OF

CLARENCE F. JACOBSON

Surveyed Sept. 23, 1975, by D. Norby