

T.26S., R.12W., W.M.

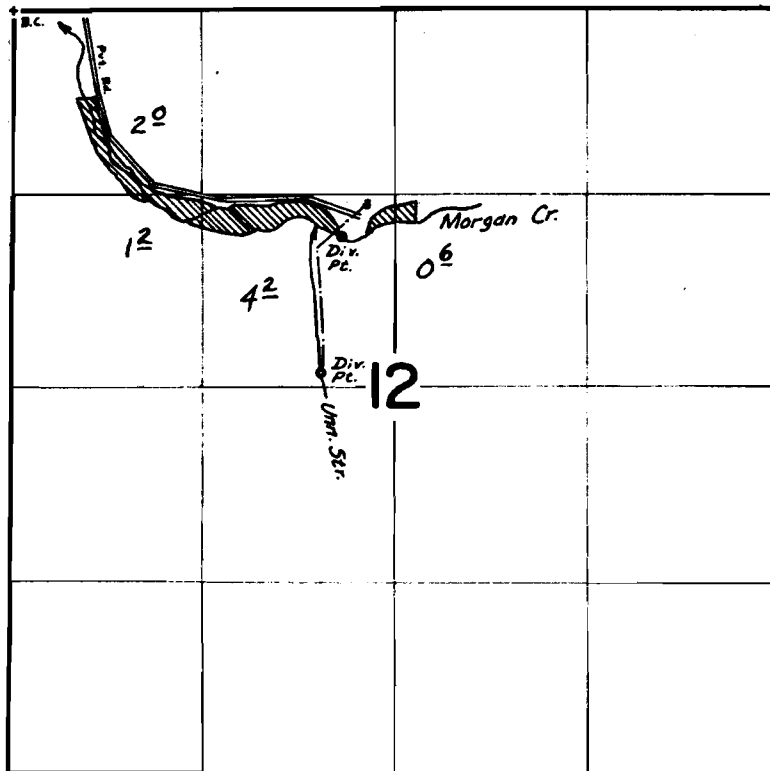

DIV. PTS. LOC: UNN. STR. - 2480'S & 2110'E; MORGAN CR. - 1550' S & 2240' E
BOTH FROM NW COR. SEC. 12

FINAL PROOF SURVEY UNDER

Application No. 44077 Permit No. 32991
44078 32992
IN NAME OF

CLARENCE F. JACOBSON

Surveyed Sept. 23 1975, by D. Norby