

T.2S.R.1W.W.M

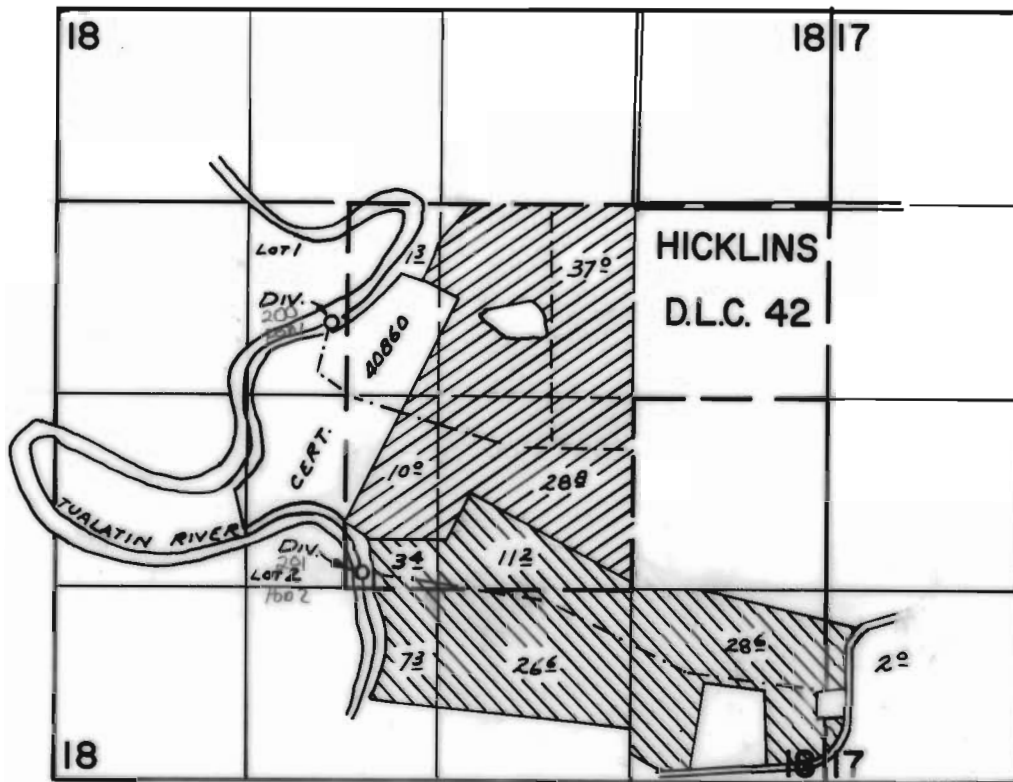

CERT. 43946 →  DENNIS  PATTIE

DIV. PTS. LOC: 810' S. & 2060' W; 2530' S. & 1840' W, BOTH FROM N.E. COR. SW $\frac{1}{4}$ NE $\frac{1}{4}$ SEC. 18

FINAL PROOF SURVEY UNDER

Application No. 48082. Permit No. 36063....
IN NAME OF

DANIEL DENNIS - HUGH L. & LUCILLE W. PATTIE

Surveyed OCT. 6, 1975, by D. NORBY....
OCT. 8, 1976
JULY 7, 1977
JAN. 15, 1980 R. G. MUCKEN