

T.38S.R.IE.W.M.

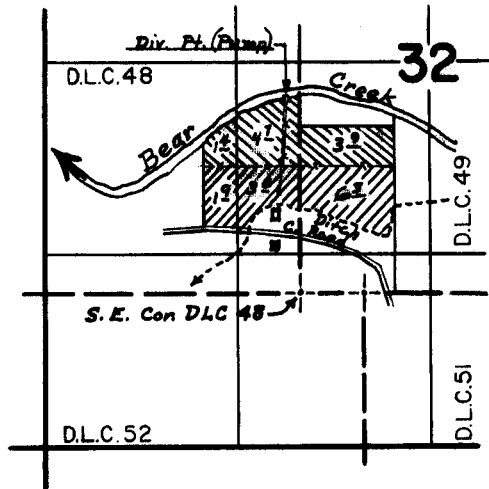

*Div. Pt. (Pump) is located 1335' N. of
95' W. from S.E. Cor. DLC 48.*

FINAL PROOF SURVEY UNDER

Transfer No. 2638 & 2639
Application No. _____ Permit No. _____
IN NAME OF

Leo J. & Marianne O. van Dijk

Surveyed Mar. 10 1976, by D.C. Hendrix