

T.8S. R.46E. W.M.

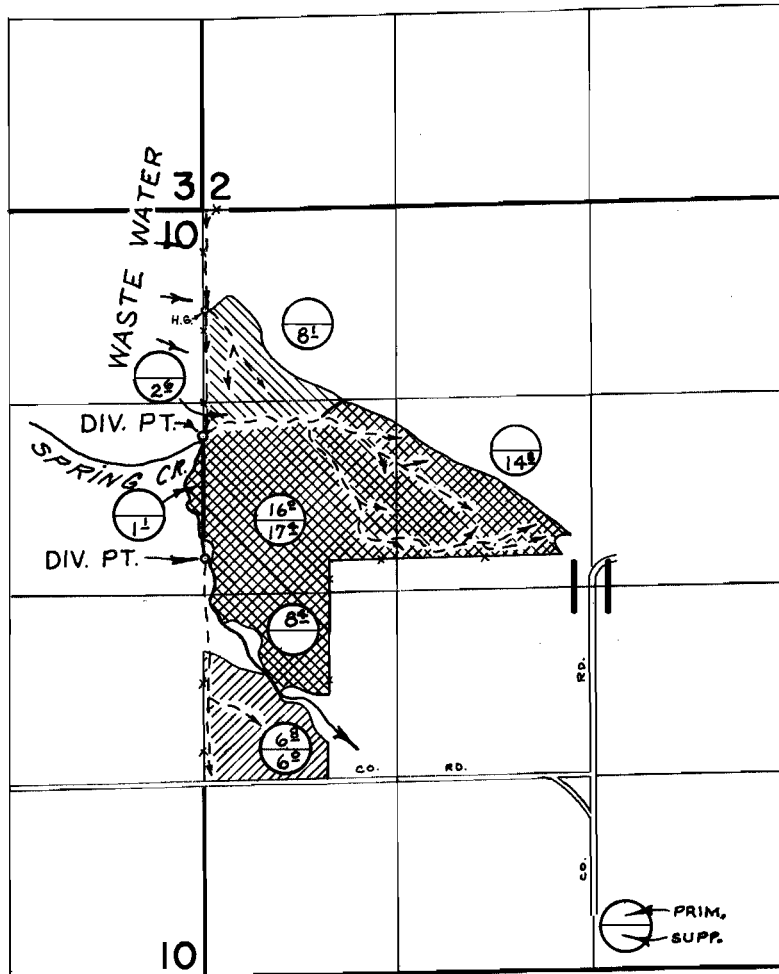

DIV. PTS. LOC.: SPRING CR. - 1540'S. 4'10"W., 2390'S. 8'10"E. BOTH FROM NW COR. SEC. 11, WASTE WATER - FROM NW COR. SEC. 11 TO A POINT 1530' STRAIGHT SOUTH.

FINAL PROOF SURVEY UNDER

Application No. 42261 Permit No. 31732
IN NAME OF

BESSIE GREENER

Surveyed AUG. 27, 1975, by R. MUCKEN